

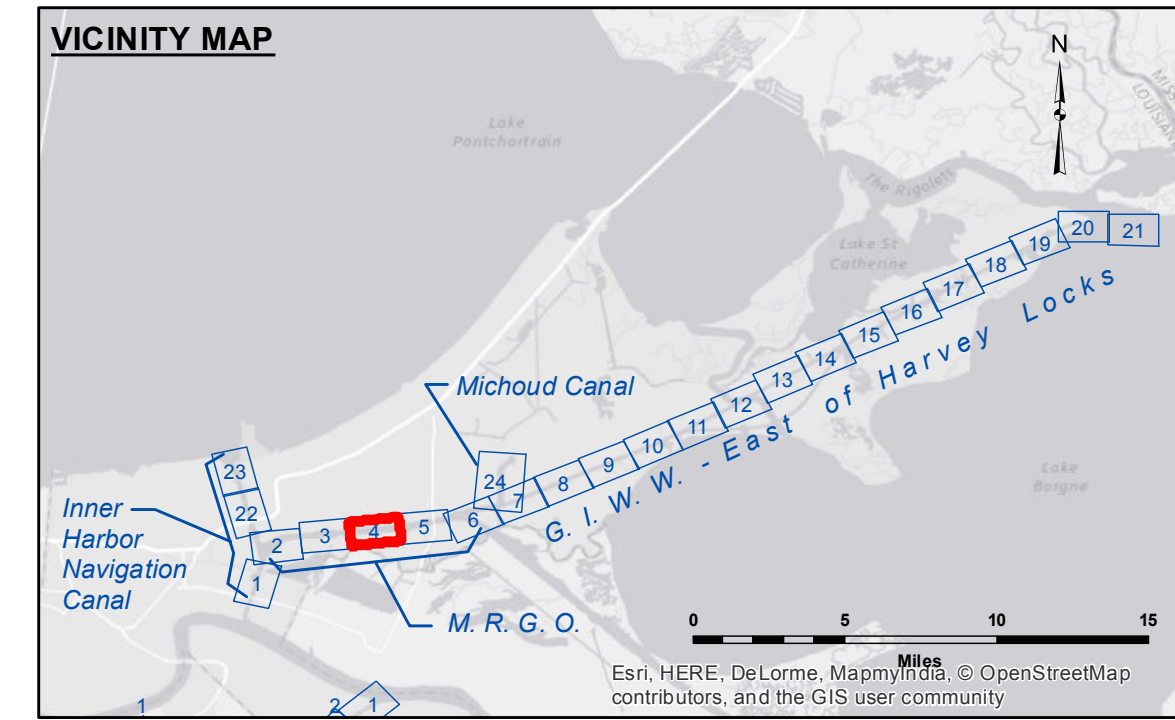

Distribution Liability: The data represents the results of data collection/processing for a specific US Army Corps of Engineers project. It is only valid for its intended use, content, time and accuracy specifications. The user is responsible for the results. The user's application of the data for other than its intended purpose, the application of the data for other than its intended purpose. Data Constants: Hydrographic survey data is subject to change due to several factors including but not limited to: changing hydrographic conditions, changes in bathymetry, changes in the hydrographical conditions when developed after the date of the survey, and changes in the hydrographical conditions when developed after the date of the survey. The information depicted on this map represents the results of a survey conducted on the ground and is not intended to be used as a substitute for a field inspection. The user is responsible for the results of the survey. The user's application of the data for other than its intended purpose, the application of the data for other than its intended purpose.

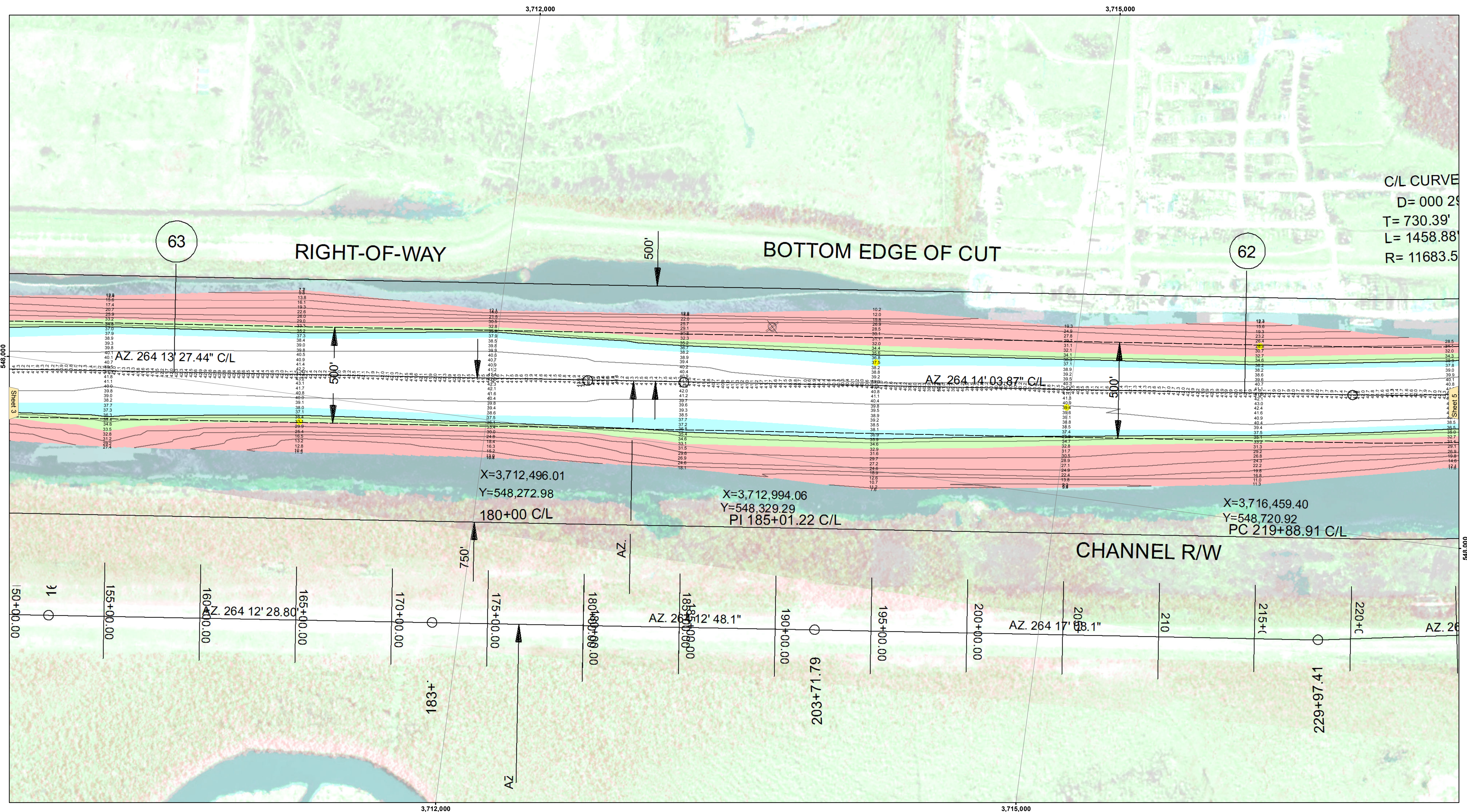

LEGEND			
--- Federal Navigation Channel	○ Cable Area	□ Borrow Area	■ -33' and above
— Federal Navigation Center Line	□ Placement Area	● Shoalest Sounding**	■ -33' to -36'
— As-built Pipeline/Cable	□ Anchorage Area	★ Beacon, General	■ -36' to -38'
..... Unconfirmed Pipeline/Cable	⊗ Obstruction Point	◆ Red Navigation Buoy	■ -38' and below
— Project Depth Contour	⚓ Wrecks-Submerged	◆ Green Navigation Buoy	

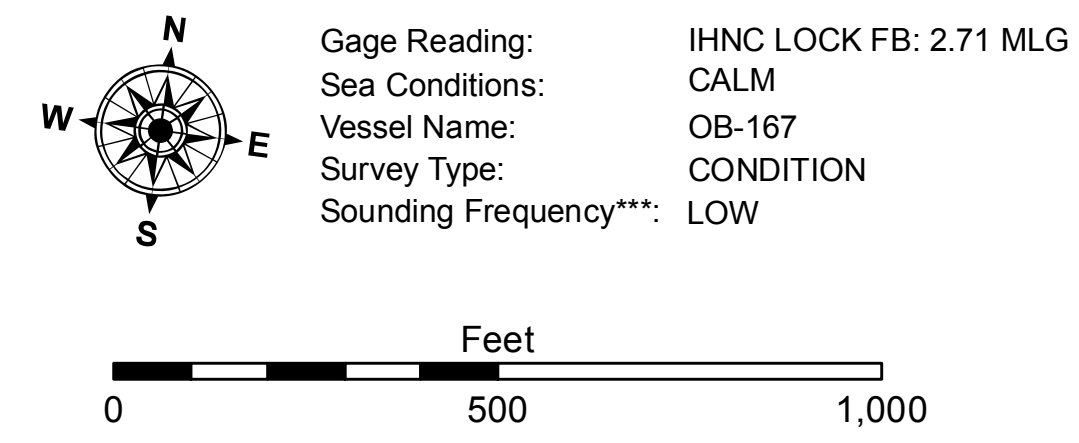

NOTES:
 Horizontal Coordinate System: North American Datum of 1983 (NAD83), projected to the State Plane Coordinate System (SPCS), Louisiana South Zone. Distance units in U.S. Survey Feet.
 Vertical Datum: Soundings are shown in feet and indicate depths below Mean Low Gulf Datum (MLG).
 The location of navigation aids are base on and provided by the U.S. Coast Guard.
 2010 Aerial Photography data source: NAIP. 1998 DOQQ imagery shown in green from USGS.
 Reference is N.O.A.A. Navigation Chart No. 11367 and 11368.
 ** Shoalest Sounding per Quarter per Reach.
 *** High frequency (200 kHz) survey data represents the first signal return at a sounding location and will include suspended solids, known as "fluff", if present. Low frequency (20 kHz) survey data normally penetrates through this "fluff" layer to depict elevations of consolidated bottom material. Low frequency accuracies may vary depending on channel conditions and fathometer settings.

U.S. ARMY CORPS OF ENGINEERS NEW ORLEANS DISTRICT			
Submitted:	Surveyed By: SPPM	Recommended:	Plotted By: BID
Checked:	Checked By: JIB	Approved:	Checked By: JIB

GULF INTRACOASTAL WATERWAY
 MRGO
 GE_04_MRG_20150313
 13 March 2015

Sheet Reference Number
 4 of 24