

--- ELEVATION MAINTAINED BY THE PORT OF NEW ORLEANS STA. 293+40 TO 333+00

- 100' OFFSET
- 150' OFFSET
- 175' OFFSET
- 200' OFFSET
- 250' OFFSET

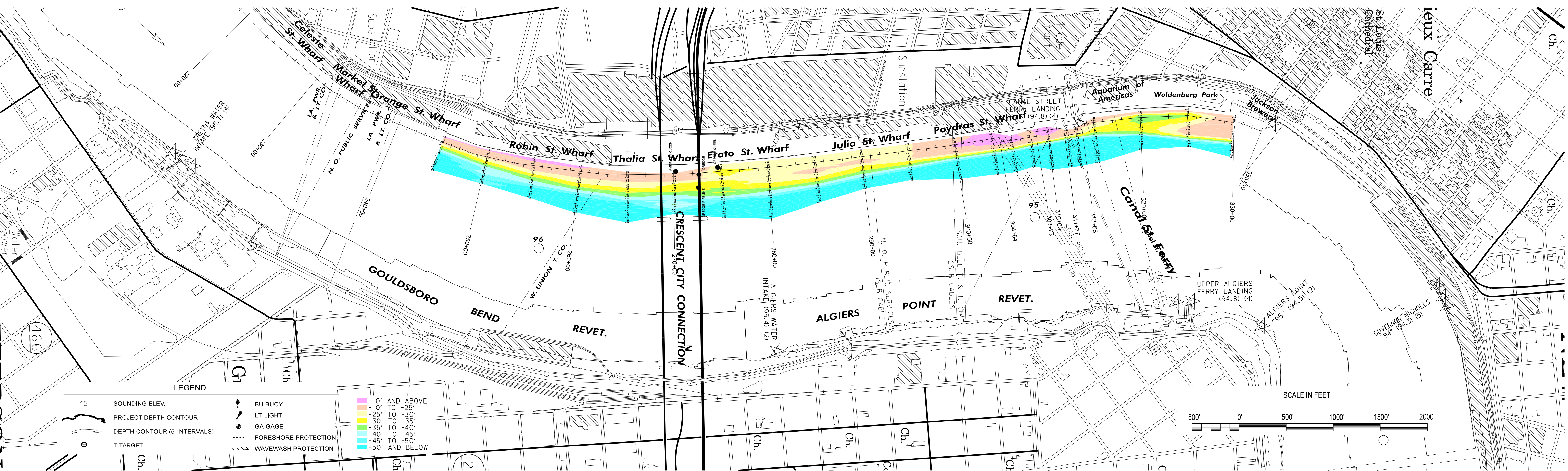

**LEGEND**

- |    |                              |                      |
|----|------------------------------|----------------------|
| 45 | SOUNDING ELEV.               | BU-BUOY              |
| —  | PROJECT DEPTH CONTOUR        | LT-LIGHT             |
| —  | DEPTH CONTOUR (5' INTERVALS) | GA-GAGE              |
| —  | T-TARGET                     | FORESHORE PROTECTION |
|    |                              | WAVEWASH PROTECTION  |
- 
- |   |                |
|---|----------------|
| — | -10' AND ABOVE |
| — | -10' TO -25'   |
| — | -25' TO -30'   |
| — | -30' TO -35'   |
| — | -35' TO -40'   |
| — | -40' TO -45'   |
| — | -45' TO -50'   |
| — | -50' AND BELOW |

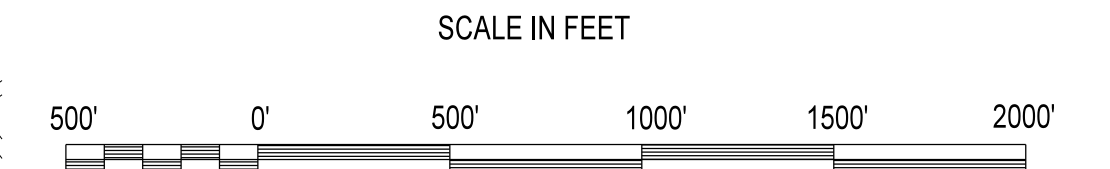

U.S. ARMY CORPS OF ENGINEERS  
 NEW ORLEANS DISTRICT  
 NEW ORLEANS, LOUISIANA

OPERATIONS DIVISION  
 TECHNICAL SUPPORT BRANCH  
 CHANNEL SURVEY SECTION

TECHNICIAN: MOLLERE/SOUKI  
 SURVEY VESSEL: MV 7 OB167  
 FREQUENCY: 200 KHZ  
 PROCESSED BY: AO  
 CHECKED BY: MK

**MISSISSIPPI RIVER  
 HYDROGRAPHIC SURVEY  
 NEW ORLEANS HARBOR**

MR\_54\_NO1 - Sta. 0+00 to 160+00

NOTES:  
 ALL ELEVATIONS ARE EXPRESSED IN FEET AND REFER TO MEAN LOW GULF (MLG) RELATIVE TO THE NATIONAL GEODETIC VERTICAL DATUM OF 1929 (NGVD 29) IN 1973. CONTOURS ABOVE AND BELOW MLG ARE EXPRESSED IN FEET AT 5 FT. INTERVALS. ALL AZIMUTHS ARE GEODETIC AND TURNED CLOCKWISE FROM 0 ( TRUE NORTH ).

○ DISTANCES ON THE MISSISSIPPI RIVER ARE SHOWN AT 1 MILE INTERVALS.

PROJECTION..... LAMBERT CONFORMAL CONIC  
 (EX: 30°28' 0" )  
 SYSTEM..... STATE PLANE, LOUISIANA SOUTH, ZONE 1702  
 (EX: 715,000 )  
 HORIZONTAL DATUM..... NORTH AMERICAN DATUM 1983 (NAD 83)  
 VERTICAL DATUM..... MEAN LOW GULF (MLG)

LWRP: N/A  
 GAGE READING: HARVEY/IHNC AVG: 10.5 MLG  
 DATE OF LAST SURVEY: 21 APR 2016  
 CODES: SINGLE-BEAM  
 SURVEY CONDITION: CALM

FILENAME/SURVEY DATE:  
 03 MAY 2016

SHEET IDENTIFICATION