

— ELEVATION MAINTAINED BY THE PORT OF NEW ORLEANS STA. 293+40 TO 333+00

- 100' OFFSET
- 150' OFFSET
- 200' OFFSET
- 250' OFFSET

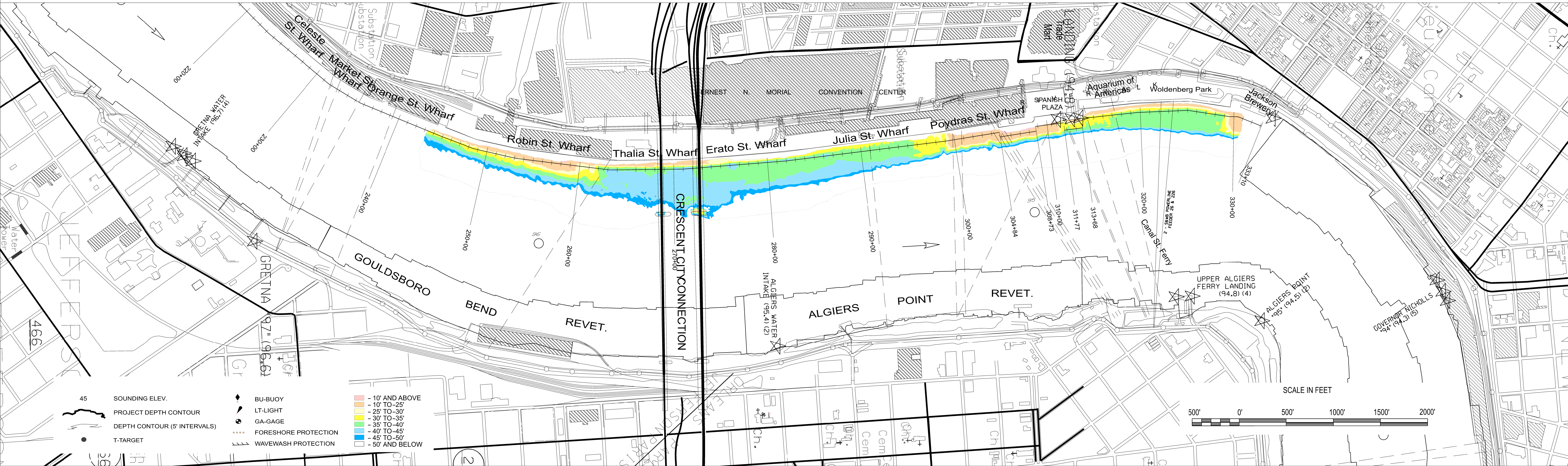

- 45 SOUNDING ELEV.
- PROJECT DEPTH CONTOUR
- DEPTH CONTOUR (5' INTERVALS)
- T-TARGET
- BU-BUOY
- LT-LIGHT
- GA-GAGE
- FORESHORE PROTECTION
- WAVEWASH PROTECTION
- 10' AND ABOVE
- 10' TO -25'
- 25' TO -30'
- 30' TO -35'
- 35' TO -40'
- 40' TO -45'
- 45' TO -50'
- 50' AND BELOW



U.S. ARMY CORPS OF ENGINEERS  
NEW ORLEANS DISTRICT  
NEW ORLEANS, LOUISIANA  
  
OPERATIONS DIVISION  
TECHNICAL SUPPORT BRANCH  
CHANNEL SURVEY SECTION

TECHNICIAN: PM, SP  
SURVEY VESSEL: OB-167  
FREQUENCY: 400 kHz  
PROCESSED BY: BD  
CHECKED BY: AO

**MISSISSIPPI RIVER  
HYDROGRAPHIC SURVEY  
NEW ORLEANS HARBOR**  
MR\_56\_NO3 - Sta. 220+00 to 333+10

NOTES:  
ALL ELEVATIONS IN FEET AND REFER TO LOW WATER REFERENCE PLANE (LWRP07) RELATIVE TO THE NORTH AMERICAN VERTICAL DATUM OF 1988 (NAVD88). CONTOURS ABOVE AND BELOW LWRP ARE EXPRESSED IN FEET AT 5 FT. INTERVALS. ALL AZIMUTHS ARE GEODETIC AND TURNED CLOCKWISE FROM 0 ( TRUE NORTH ).  
○ DISTANCES ON THE MISSISSIPPI RIVER ARE SHOWN AT 1 MILE INTERVALS.

PROJECTION..... LAMBERT CONFORMAL CONIC  
(EX: -30°28' 0" )  
SYSTEM..... STATE PLANE, LOUISIANA SOUTH, ZONE 1702  
(EX: - 715,000 )  
HORIZONTAL DATUM..... NORTH AMERICAN DATUM 1983 (NAD 83)  
VERTICAL DATUM..... LOW WATER REFERENCE PLANE (LWRP07)

LWRP: N/A  
GAGE READING: VRS: 3.87 LWRP  
DATE OF LAST SURVEY: 02 JUL 2020  
CODES: MULTIBEAM  
SURVEY CONDITION: CALM

FILENAME/SURVEY DATE:  
**23 JUL 2020**

SHEET IDENTIFICATION  
**56**