

ELEVATION MAINTAINED BY THE PORT OF NEW ORLEANS STA. 293+40 TO 333+00

- 100' OFFSET
- 150' OFFSET
- 200' OFFSET
- 250' OFFSET

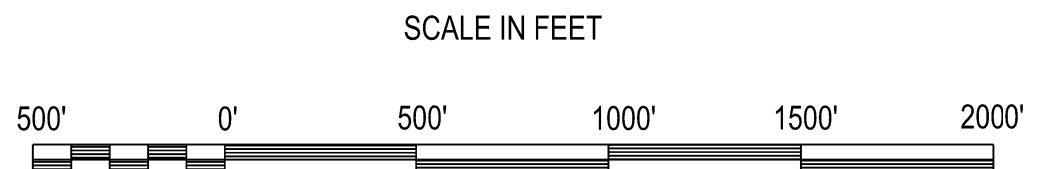
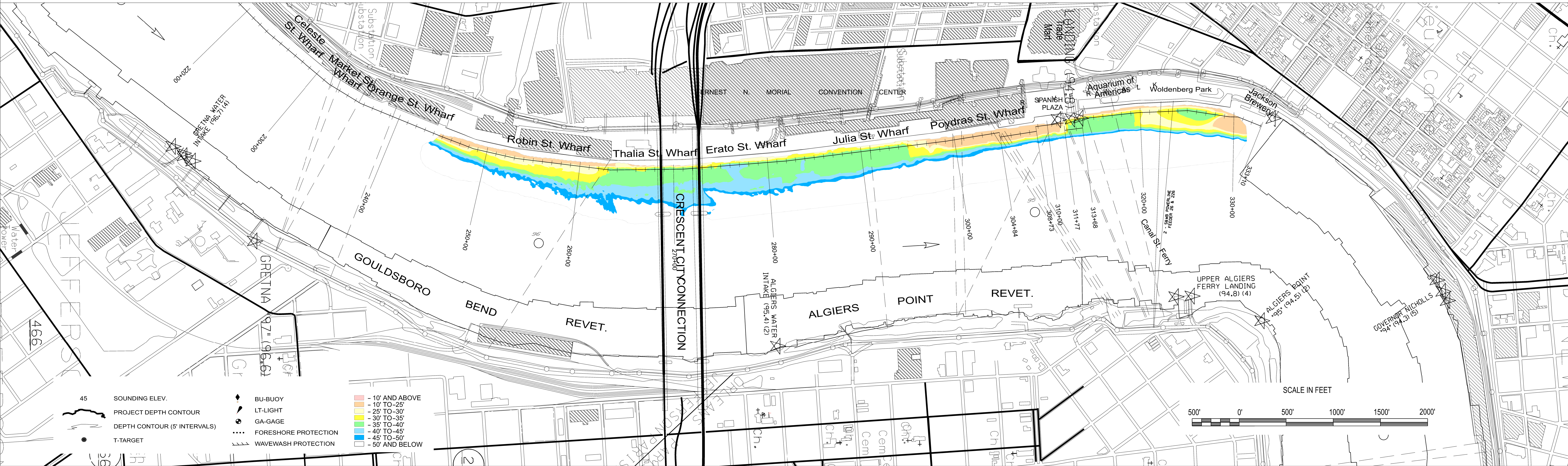

U.S. ARMY CORPS OF ENGINEERS
 NEW ORLEANS DISTRICT
 NEW ORLEANS, LOUISIANA

OPERATIONS DIVISION
 TECHNICAL SUPPORT BRANCH
 CHANNEL SURVEY SECTION

TECHNICIAN: PM, SP
 SURVEY VESSEL: OB-167
 FREQUENCY: 400 kHz
 PROCESSED BY: BD
 CHECKED BY: AO

**MISSISSIPPI RIVER
 HYDROGRAPHIC SURVEY
 NEW ORLEANS HARBOR**

MR_56_NO3 - Sta. 220+00 to 333+10

NOTES:
 ALL ELEVATIONS IN FEET AND REFER TO LOW WATER REFERENCE PLANE (LWRP07) RELATIVE TO THE NORTH AMERICAN VERTICAL DATUM OF 1988 (NAVD88). CONTOURS ABOVE AND BELOW LWRP ARE EXPRESSED IN FEET AT 5 FT. INTERVALS. ALL AZIMUTHS ARE GEODETIC AND TURNED CLOCKWISE FROM 0 (TRUE NORTH).

○ DISTANCES ON THE MISSISSIPPI RIVER ARE SHOWN AT 1 MILE INTERVALS.

PROJECTION..... LAMBERT CONFORMAL CONIC
 (EX: 30° 28' 0")
 SYSTEM..... STATE PLANE, LOUISIANA SOUTH, ZONE 1702
 (EX: 715,000)
 HORIZONTAL DATUM..... NORTH AMERICAN DATUM 1983 (NAD 83)
 VERTICAL DATUM..... LOW WATER REFERENCE PLANE (LWRP07)

LWRP: N/A
 GAGE READING: VRS: 2.13 LWRP
 DATE OF LAST SURVEY: 27 MAY 2022
 CODES: MULTIBEAM
 SURVEY CONDITION: CALM

FILENAME/SURVEY DATE:
13 JUL 2022

SHEET IDENTIFICATION
56