



**DISCLAIMER:** The United States Government furnishes these data and the recipient accepts and uses them with the express understanding that the Government makes no warranty, expressed or implied, regarding the accuracy, completeness, reliability, usability or suitability for any particular purpose of the information. The user is responsible for the results obtained from the application of the data for other than its intended purpose.

**DISTRIBUTION STATEMENT:** This document is classified as "Unclassified" and is available to the public. It is not to be distributed outside the United States without the express approval of the United States Army Corps of Engineers. The information contained in this document is the property of the United States Army Corps of Engineers and is not to be distributed, in any form, to other agencies or individuals without the express approval of the United States Army Corps of Engineers. The information contained in this document is not to be used for any purpose other than that for which it was prepared.

**DATE:** 07 August 2017

Submitted:	Surveyed By:	SPS,JH
Recommended:	Plotted By:	BD
Approved:	Checked By:	AC

U.S. ARMY CORPS OF ENGINEERS  
NEW ORLEANS DISTRICT

**OLD RIVER LOCK VICINITY**  
**OLD RIVER LOCK TAILBAY**  
**OR\_02\_LTB\_20170807\_CS**  
**07 August 2017**

**Sheet Reference Number**  
**2 of 4**

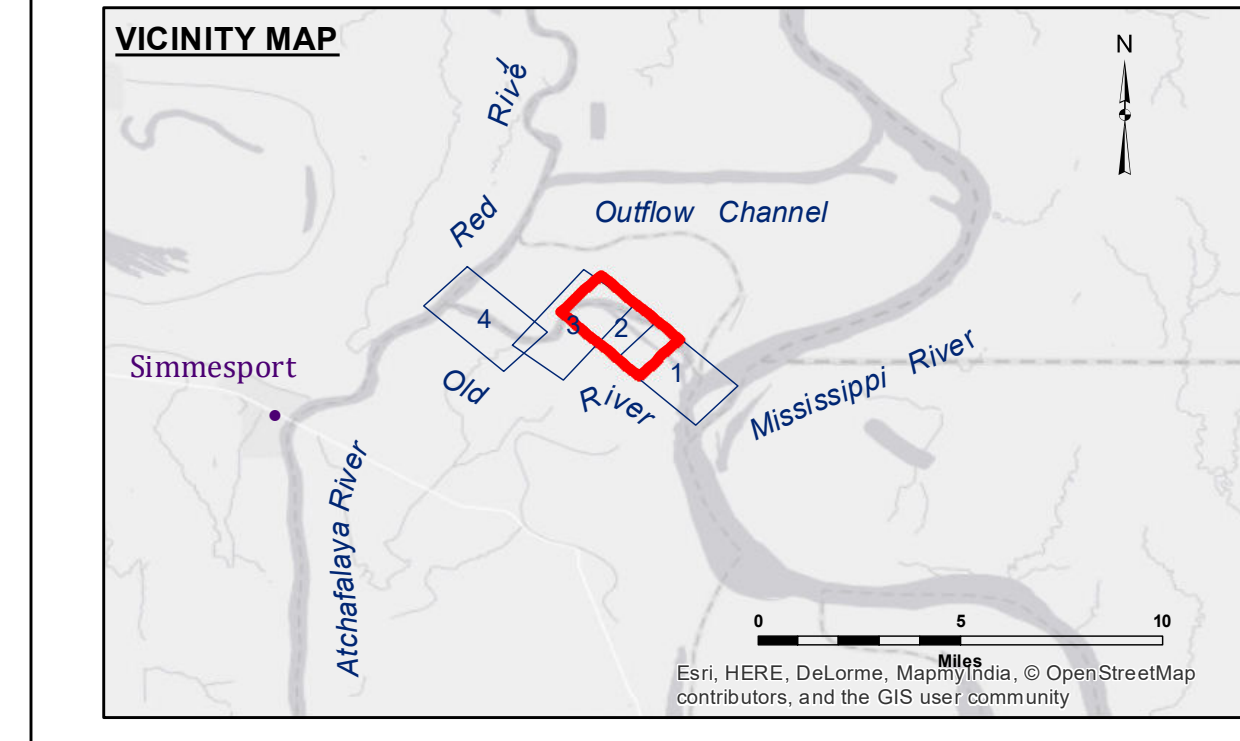
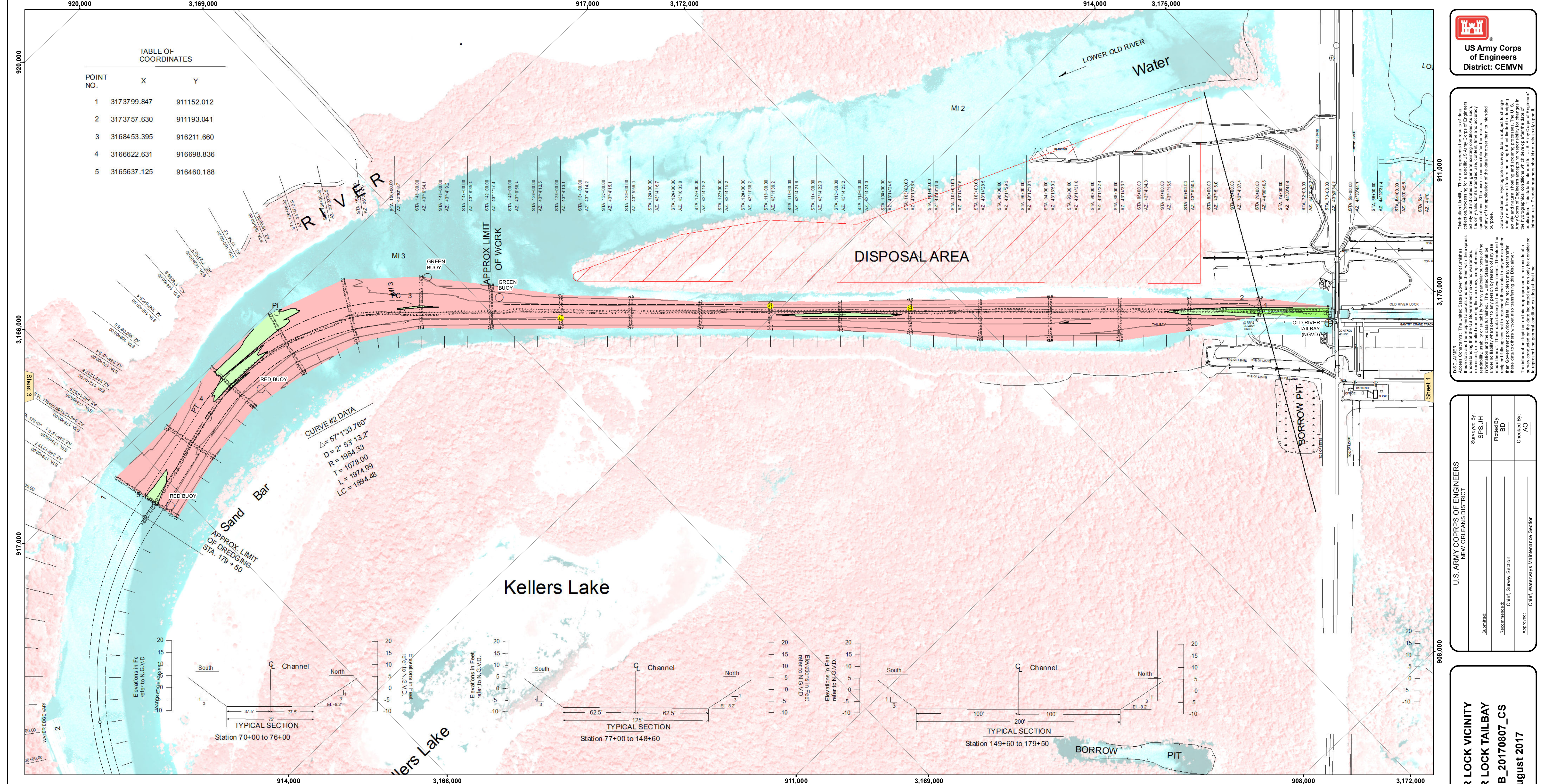

**LEGEND**

--- Federal Navigation Channel	● Cable Area	□ Borrow Area	■ -8' and above
— Federal Navigation Center Line	□ Placement Area	● Shoalest Sounding**	■ -8' to -10'
— As-built Pipeline/Cable	□ Anchorage Area	★ Beacon, General	■ -10' to -12'
..... Unconfirmed Pipeline/Cable	✕ Obstruction Point	♦ Red Navigation Buoy	■ -12' and below
— Project Depth Contour	✎ Wrecks-Submerged	◆ Green Navigation Buoy	

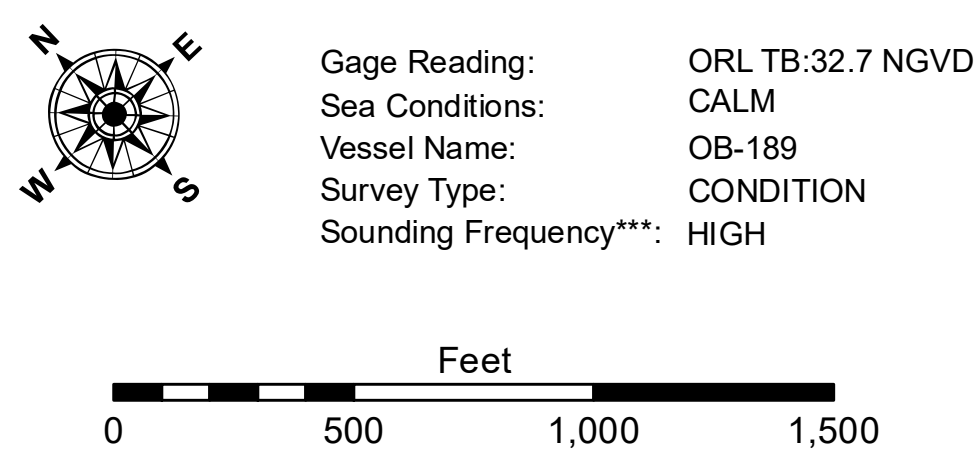

**NOTES:**  
 Horizontal Coordinate System:  
 North American Datum of 1983 (NAD83), projected to the State Plane Coordinate System (SPCS), Louisiana South Zone. Distance units in U.S. Survey Feet.  
 Vertical Datum:  
 Soundings are shown in feet and indicate depths below National Geodetic Vertical Datum of 1929 (NGVD29).  
 The location of navigation aids are based on and provided by the U.S. Coast Guard. Positions of navigation aids shown may also have been surveyed in the field by USACE.  
 2010 Aerial Photography data source: NAIP, 1998 DOQQ imagery shown in green from USGS.  
 Reference is N.O.A.A. Navigation Chart No. 11354.  
 \*\* Shoalest Sounding per Quarter per Reach.  
 \*\*\* High frequency (200 kHz) survey data represents the first signal return at a sounding location and will include suspended solids, known as "fluff", if present. Low frequency (20 kHz) survey data normally penetrates through this "fluff" layer to depict elevations of consolidated bottom material. Low frequency accuracies may vary depending on channel conditions and fathometer settings.