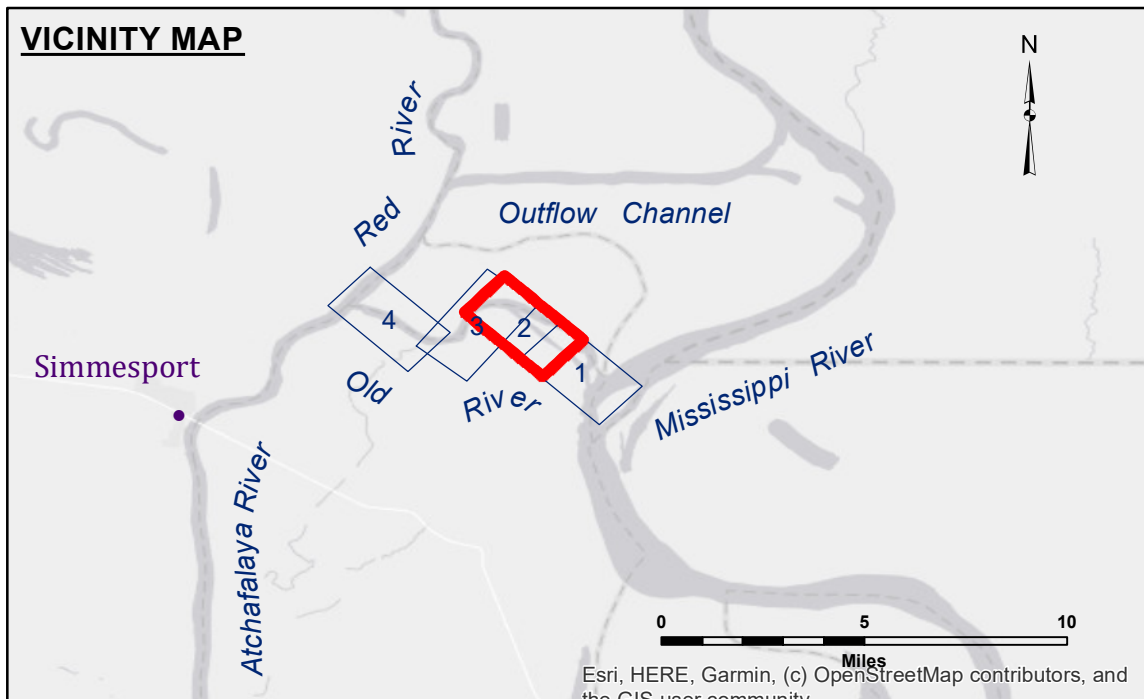
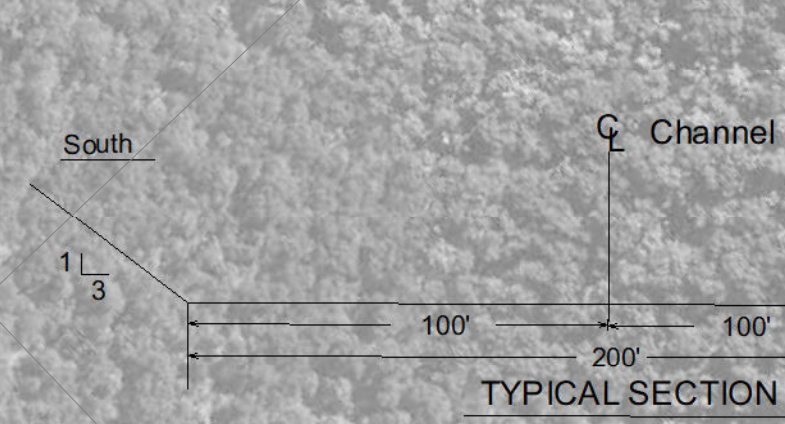
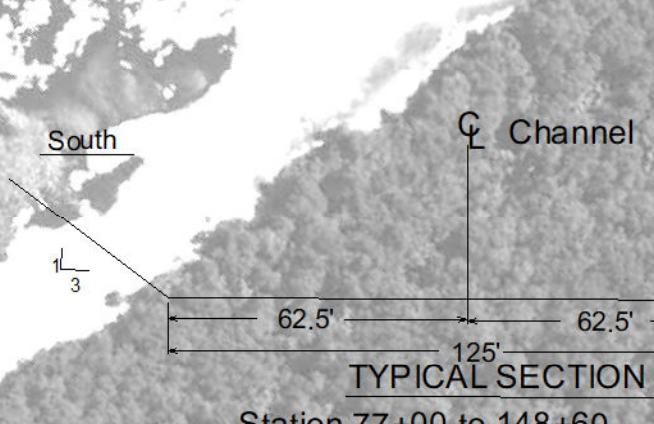
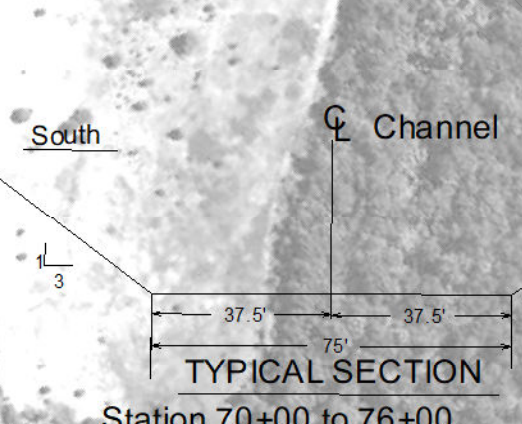

**TABLE OF COORDINATES**

POINT NO.	X	Y
1	3173799.847	911152.012
2	3173757.630	911193.041
3	3168453.395	916211.660
4	3166622.631	916698.836
5	3165637.125	916460.188

**CURVE #2 DATA**  
 $\Delta = 57^\circ 13' 37.60''$   
 $D = 2^\circ 53' 13.2''$   
 $R = 1984.33$   
 $T = 1078.00$   
 $L = 1974.99$   
 $LC = 1894.48$

**APPROX LIMIT OF DREDGING**  
 STA. 179+50



**LEGEND**

--- Federal Navigation Channel	○ Cable Area	□ Borrow Area	■ -8' and above
— Federal Navigation Center Line	□ Placement Area	● Shoalest Sounding**	■ -8' to -10'
— As-built Pipeline/Cable	□ Anchorage Area	★ Beacon, General	■ -10' to -12'
..... Unconfirmed Pipeline/Cable	⊗ Obstruction Point	◆ Red Navigation Buoy	■ -12' and below
— Project Depth Contour	⚓ Wrecks-Submerged	◆ Green Navigation Buoy	

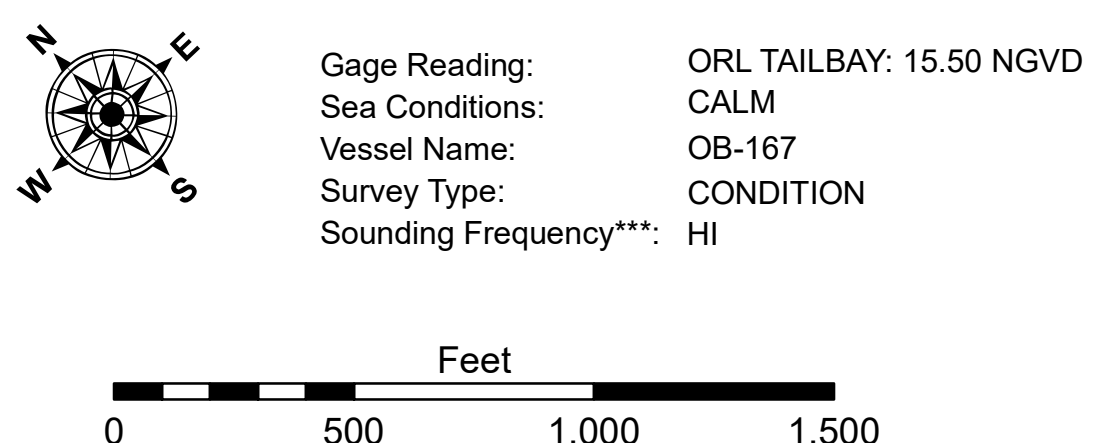

**DISCLAIMER**

The United States Government furnishes these data and the recipient accepts and uses them with the express understanding that the Government makes no warranty, expressed or implied, concerning the accuracy, completeness, reliability, usability or suitability for any particular purpose of the information. The user is responsible for the results obtained from the application of the data for other than its intended purpose.

Data Constants Hydrographic survey data is subject to change rapidly due to several factors including but not limited to changing hydrographic conditions, changes in bathymetry, and changes in the hydrographic conditions when developed after the date of the survey. The recipient may not transfer, disseminate, or use these data to others without also transferring this Disclaimer.

The information depicted on this map represents the results of a survey conducted by the United States Army Corps of Engineers and is not intended to represent the general condition existing at that time.

**U.S. ARMY CORPS OF ENGINEERS**  
 NEW ORLEANS DISTRICT

Submitted:	Surveyed By: PM,JA
Recommended: Chief, Survey Section	Plotted By: BD
Approved: Chief, Waterways Maintenance Section	Checked By: AC

**OLD RIVER LOCK VICINITY**  
**OLD RIVER LOCK TAILBAY**  
**OR\_02\_LTB\_20220615\_CS**  
**15 June 2022**

**Sheet Reference Number**  
**2 of 4**