

**G.I.W.W. CHANNEL C/L
X,Y COORDINATES**

- x = 3,165,637.12 y = 916,460.18
- x = 3,164,150.51 y = 915,448.24
- x = 3,163,839.42 y = 914,873.43
- x = 3,163,150.25 y = 913,099.57
- x = 3,161,461.76 y = 911,823.89

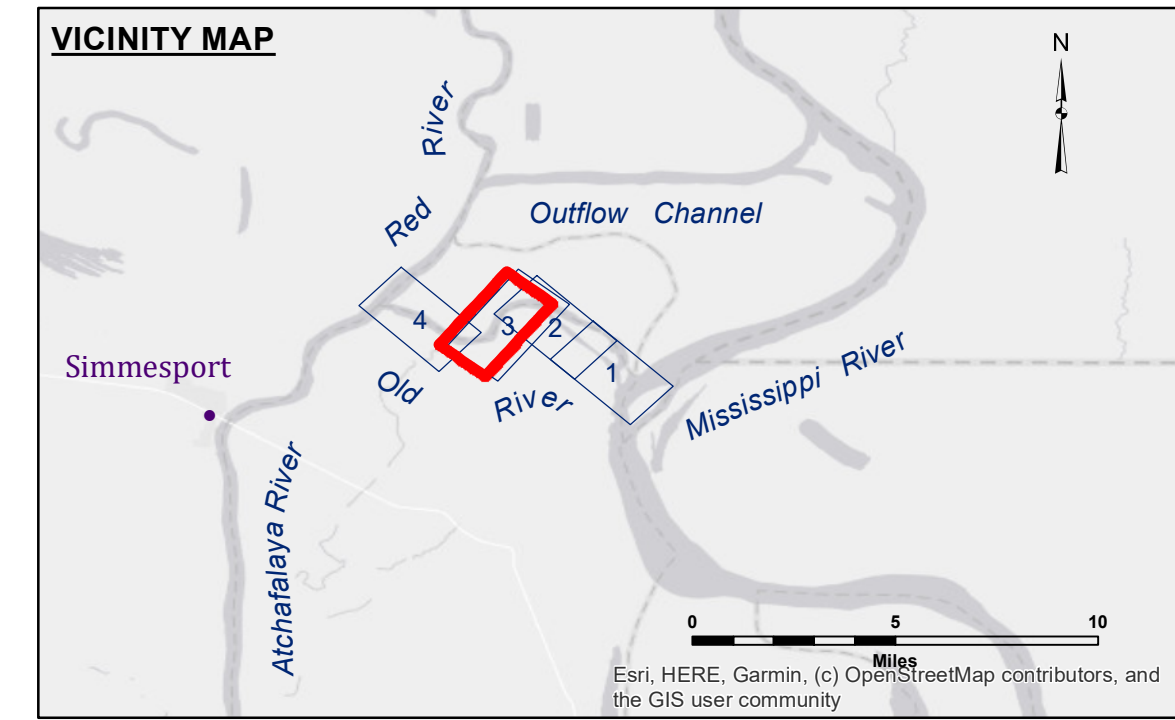
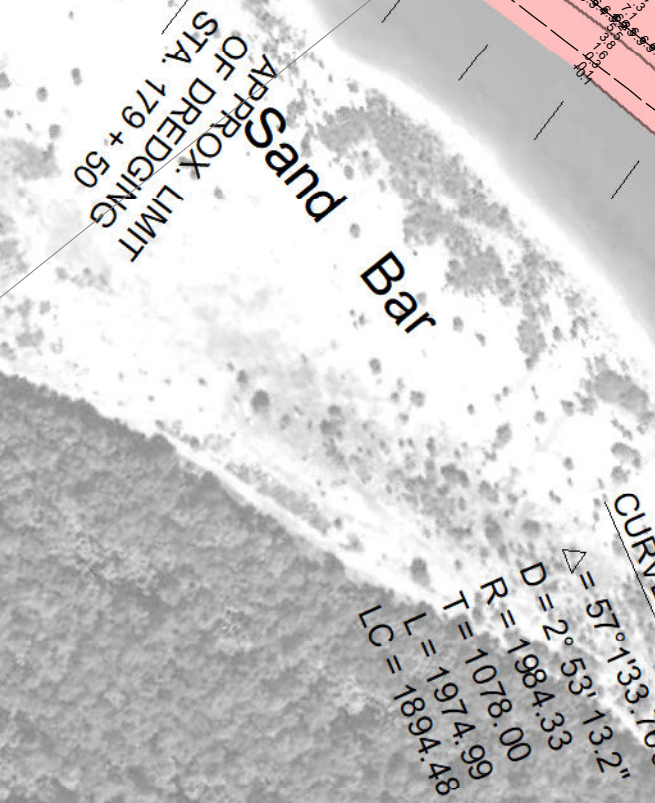
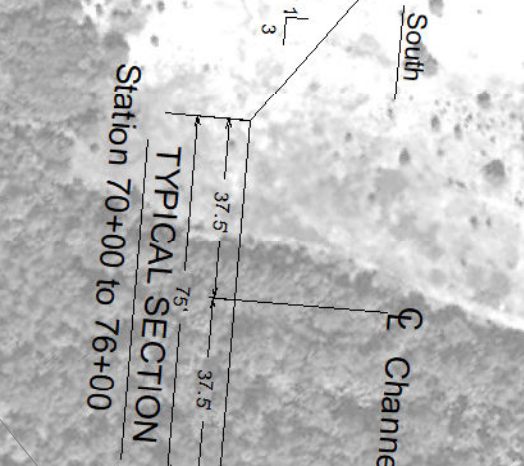

LEGEND

--- Federal Navigation Channel	○ Cable Area	□ Borrow Area	■ -8' and above
— Federal Navigation Center Line	□ Placement Area	● Shoalest Sounding**	■ -8' to -10'
— As-built Pipeline/Cable	□ Anchorage Area	☆ Beacon, General	■ -10' to -12'
..... Unconfirmed Pipeline/Cable	⊗ Obstruction Point	◆ Red Navigation Buoy	■ -12' and below
— Project Depth Contour	⚓ Wrecks-Submerged	◆ Green Navigation Buoy	

NOTES:

Horizontal Coordinate System:
North American Datum of 1983 (NAD83), projected to the State Plane
Coordinate System (SPCS), Louisiana South Zone. Distance units in U.S. Survey Feet.

Vertical Datum:
Soundings are shown in feet and indicate depths below National Geodetic Vertical Datum of 1929 (NGVD29).

The location of navigation aids are based on and provided by the U.S. Coast Guard. Positions of navigation aids shown may also have been surveyed in the field by USACE.

2015 Aerial Photography data source: NAIP, 1998 DOQQ imagery shown in green from USGS.

Reference is N.O.A.A. Navigation Chart No. 11354.

** Shoalest Sounding per Quarter per Reach.

*** High frequency (200 kHz) survey data represents the first signal return at a sounding location and will include suspended solids, known as "fluff", if present. Low frequency (20 kHz) survey data normally penetrates through this "fluff" layer to depict elevations of consolidated bottom material. Low frequency accuracies may vary depending on channel conditions and fathometer settings.

Gage Reading: ORL TB: 4.90 NGVD AVG.
Sea Conditions: CALM.
Vessel Name: OB-189
Survey Type: CS
Sounding Frequency***: HIGH

Scale: 0 500 1,000 1,500 Feet



DISCLAIMER

The United States Government furnishes these data and the recipient accepts and uses them with the express understanding that the data are not to be used for any purpose other than that for which they were prepared, and that the Government makes no warranty, expressed or implied, concerning the accuracy, completeness, or reliability of the data. The user is responsible for the results of any use of the data, and the Government shall not be held liable for any damage or injury resulting from the use of the data.

The information depicted on this map represents the results of a survey conducted on or about the date of the survey. The user is responsible for the results of any use of the data, and the Government shall not be held liable for any damage or injury resulting from the use of the data.

U.S. ARMY CORPS OF ENGINEERS
NEW ORLEANS DISTRICT

Submitted:	Surveyed By: RYLANDS/SIMMONS
Recommended: Chief, Survey Section	Placed By: BD
Approved: Chief, Waterways Maintenance Section	Checked By: AD/JH

**OLD RIVER LOCK VICINITY
THREE RIVERS 1
OR_03_3R1_20241107_CS
07 November 2024**

**Sheet Reference Number
3 of 4**

Revision Number:
4.2-20240420