

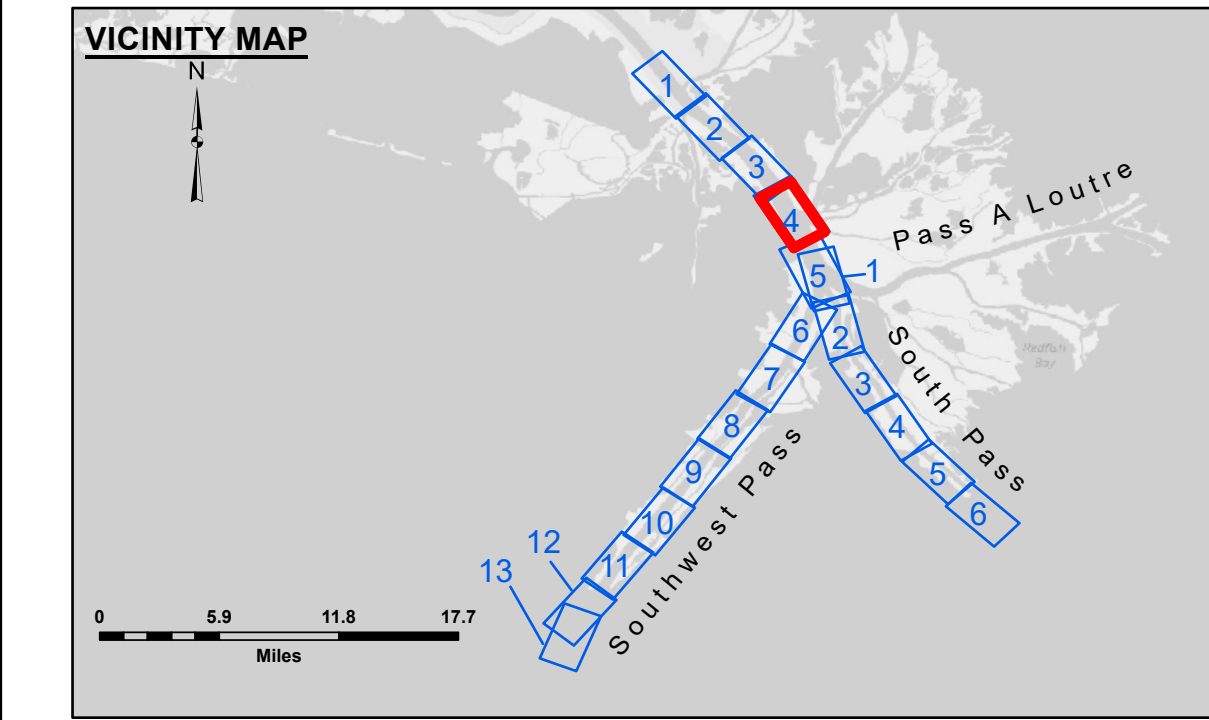

DISCLAIMER: The data represented on this map represents the results of a data collection/processing for a specific US Army Corps of Engineers activity and is not intended for use for any other purpose. The user is responsible for the results of any application of the data for other than its intended purpose. The Corps does not warrant the accuracy, completeness, or reliability of the data. The Corps does not assume any liability for any loss or damage, including consequential, special, or exemplary damages, resulting from the use of the data. The Corps does not assume any liability for any loss or damage, including consequential, special, or exemplary damages, resulting from the use of the data. The Corps does not assume any liability for any loss or damage, including consequential, special, or exemplary damages, resulting from the use of the data.

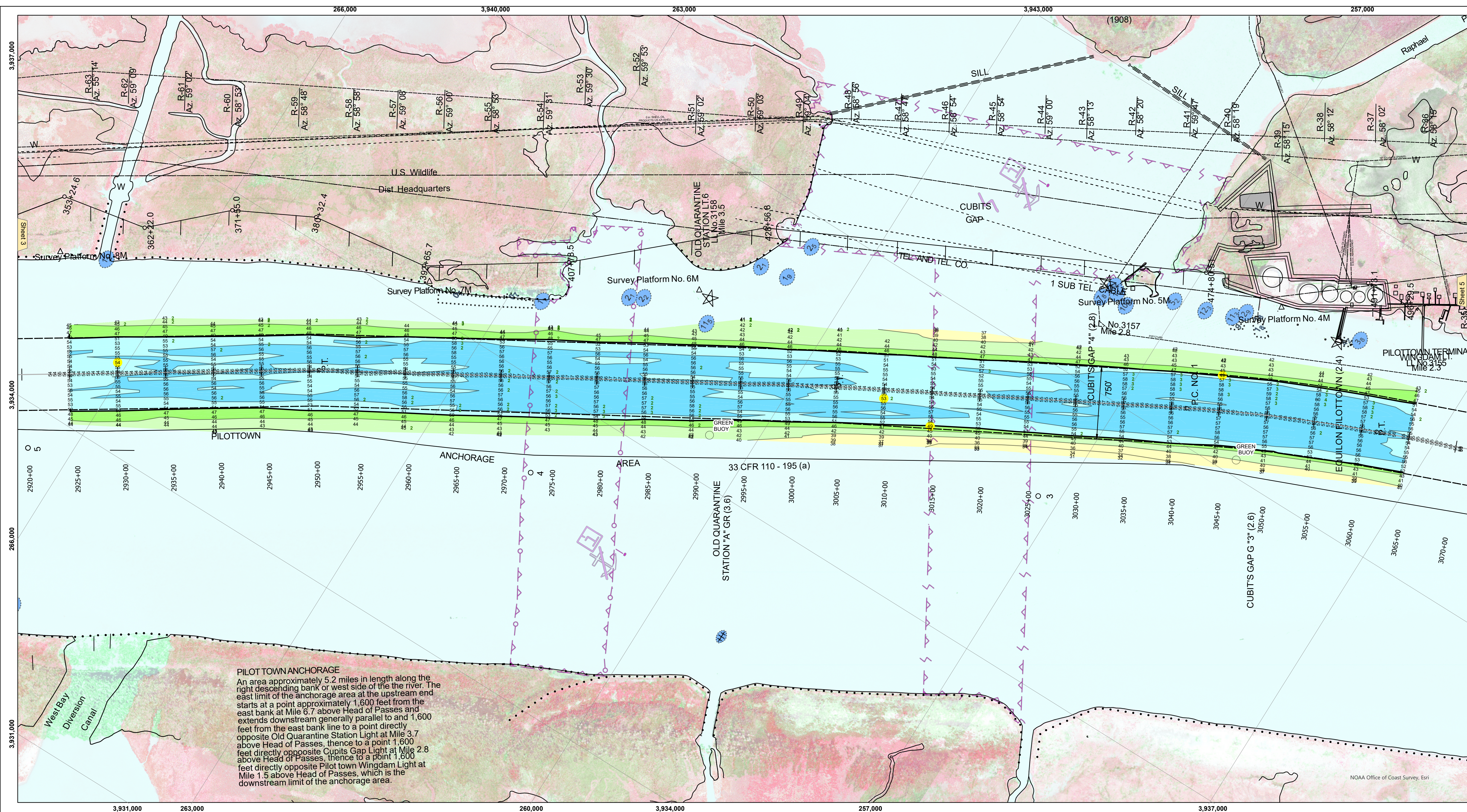

LEGEND

--- Federal Navigation Channel	○ Cable Area	3 Fluff Thickness (feet)*	■ -10' and above
— Federal Navigation Center Line	□ Placement Area	□ Borrow Area	■ -10' to -20'
— As-built Pipeline/Cable	□ Anchorage Area	● Shoalest Sounding**	■ -20' to -30'
..... Unconfirmed Pipeline/Cable	⊗ Obstruction Point	★ Beacon, General	■ -30' to -40'
— Project Depth Contour	⚓ Wrecks-Submerged	◆ Red Navigation Buoy	■ -40' to -45'
		◆ Green Navigation Buoy	■ -45' to -50'
			■ -50' to -55'
			■ -55' and below

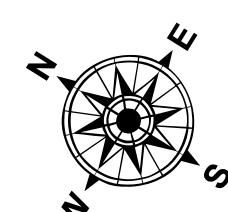

Gage Reading: 1.1 MLLW @ P.T. (01525) @ 1015
 Sea Conditions: CALM
 Vessel Name: TOBIN
 Survey Type: CONDITION, SB
 Sounding Frequency***: LOW

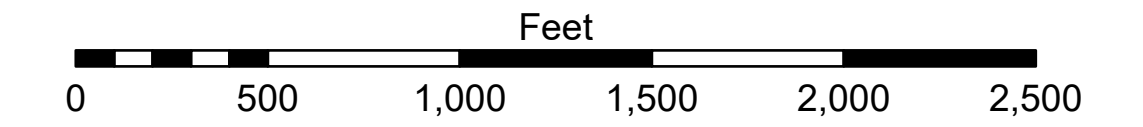

NOTES:
 Horizontal Coordinate System: North American Datum of 1983 (NAD83), projected to the State Plane Coordinate System (SPCS), Louisiana South Zone. Distance units in U.S. Survey Feet.
 Vertical Datum: Soundings are shown in feet and indicate depths below Mean Lower Low Water (MLLW, 12-16). Datum Relationships for gage 01525 as of March 2020: 0.0' NAVD83, 2009.55 = -0.53' MLLW = 2.97' MLG
 Distances on the Mississippi River, above and below Head of Passes are shown at 1 mile intervals.
 The location of navigation aids are base on and provided by the U.S. Coast Guard.
 2024 Aerial Photography data source: Optimal GEO (1998 DOQQ in green)
 Reference is N.O.A.A. Navigation Chart No. 11361.
 ** Shoalest Sounding per Quarter per Reach.
 *** High frequency (200 kHz) survey data represents the first signal return at a sounding location and will include suspended solids, known as "fluff", if present. Low frequency (24 kHz) survey data normally penetrates through this "fluff" layer to depict elevations of consolidated bottom material. Low frequency accuracies may vary depending on channel conditions and fathometer settings.

U.S. ARMY CORPS OF ENGINEERS

Submitted:	Surveyed By: JUC & RCC
Recommended: Chief, Survey Section	Plotted By: RSL
Approved: Chief, Waterways Maintenance Section	Checked By: MSK

**MISSISSIPPI RIVER - B. R. TO GULF
 SOUTHWEST PASS - SHEET 4
 SW_04_SWPX_20240819_CS
 19 August 2024**

**Sheet Reference Number
 4 of 13**