



DISCLAIMER: The data represented on this map is the result of a collection of data from various sources. The Corps of Engineers does not warrant the accuracy, completeness, or timeliness of the data. The user is responsible for the results of any application of the data for other than its intended purpose. The Corps of Engineers is not liable for any damage or injury resulting from the use of this data. The Corps of Engineers is not responsible for any errors or omissions in this data. The Corps of Engineers is not responsible for any changes in the data after the date of publication. This data is intended for use by the U.S. Army Corps of Engineers and its authorized personnel only. It is not to be used for any other purpose without the express written consent of the U.S. Army Corps of Engineers.

DISCLAIMER: The United States Government furnishes these data and the recipient accepts them with the express understanding that the data are not to be used for any purpose other than that for which they were prepared, or implied concerning the accuracy, completeness, or timeliness of the data furnished. The United States Government makes no warranty, expressed or implied, with respect to the use of the data. The recipient agrees not to represent these data to anyone as other than Government provided data. The recipient may not transfer these data to others without obtaining the permission of the U.S. Army Corps of Engineers. The information depicted on this map represents the results of a survey conducted on or about the date shown on the map. It is not to be used for any purpose other than that for which it was prepared, or implied concerning the accuracy, completeness, or timeliness of the data furnished. The United States Government makes no warranty, expressed or implied, with respect to the use of the data. The recipient agrees not to represent these data to anyone as other than Government provided data. The recipient may not transfer these data to others without obtaining the permission of the U.S. Army Corps of Engineers.

Submitted:	Surveyed By: LLB & RCC
Recommended:	Plotted By: TSS
Approved:	Checked By: MSK

U.S. ARMY CORPS OF ENGINEERS
NEW ORLEANS DISTRICT

**MISSISSIPPI RIVER - B. R. TO GULF
SOUTHWEST PASS - SHEET 4
SW_04_SWPX_20241120_CS
20 November 2024**

**Sheet
Reference
Number
4 of 13**

Revision Number:
5.23.12.3-3.23.12.3

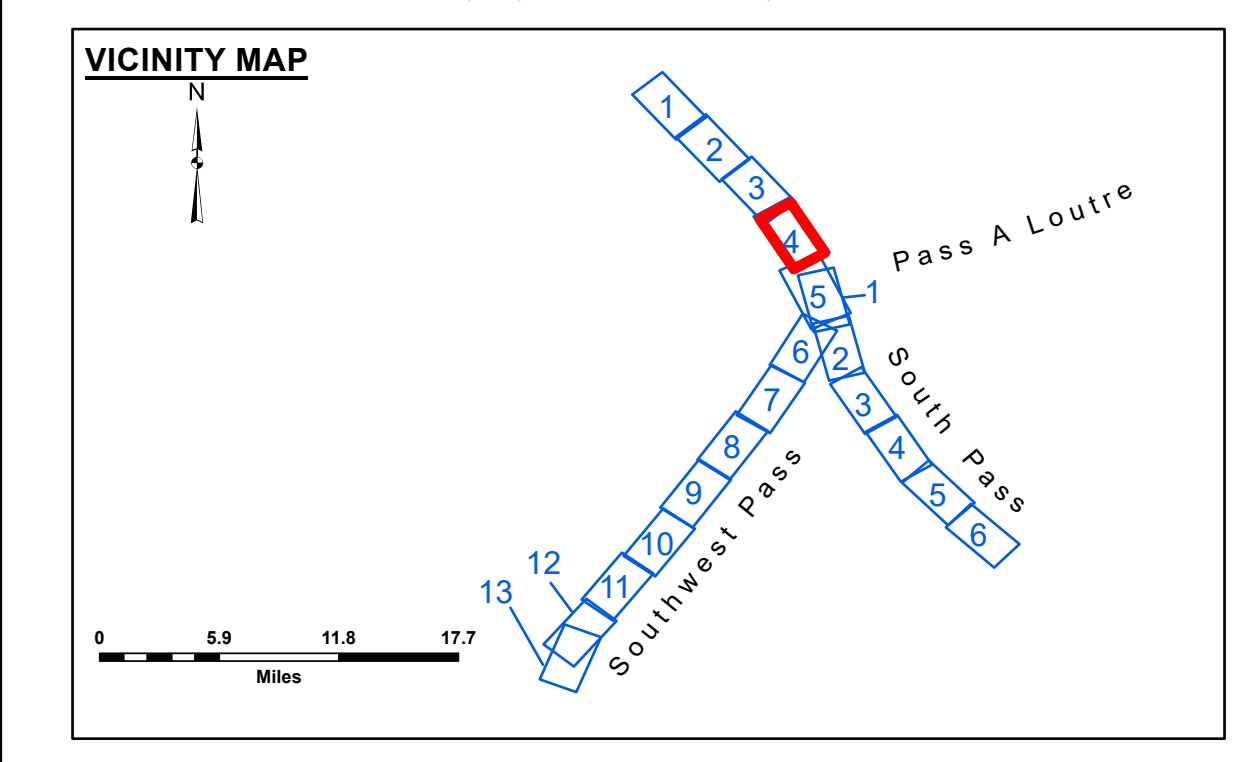
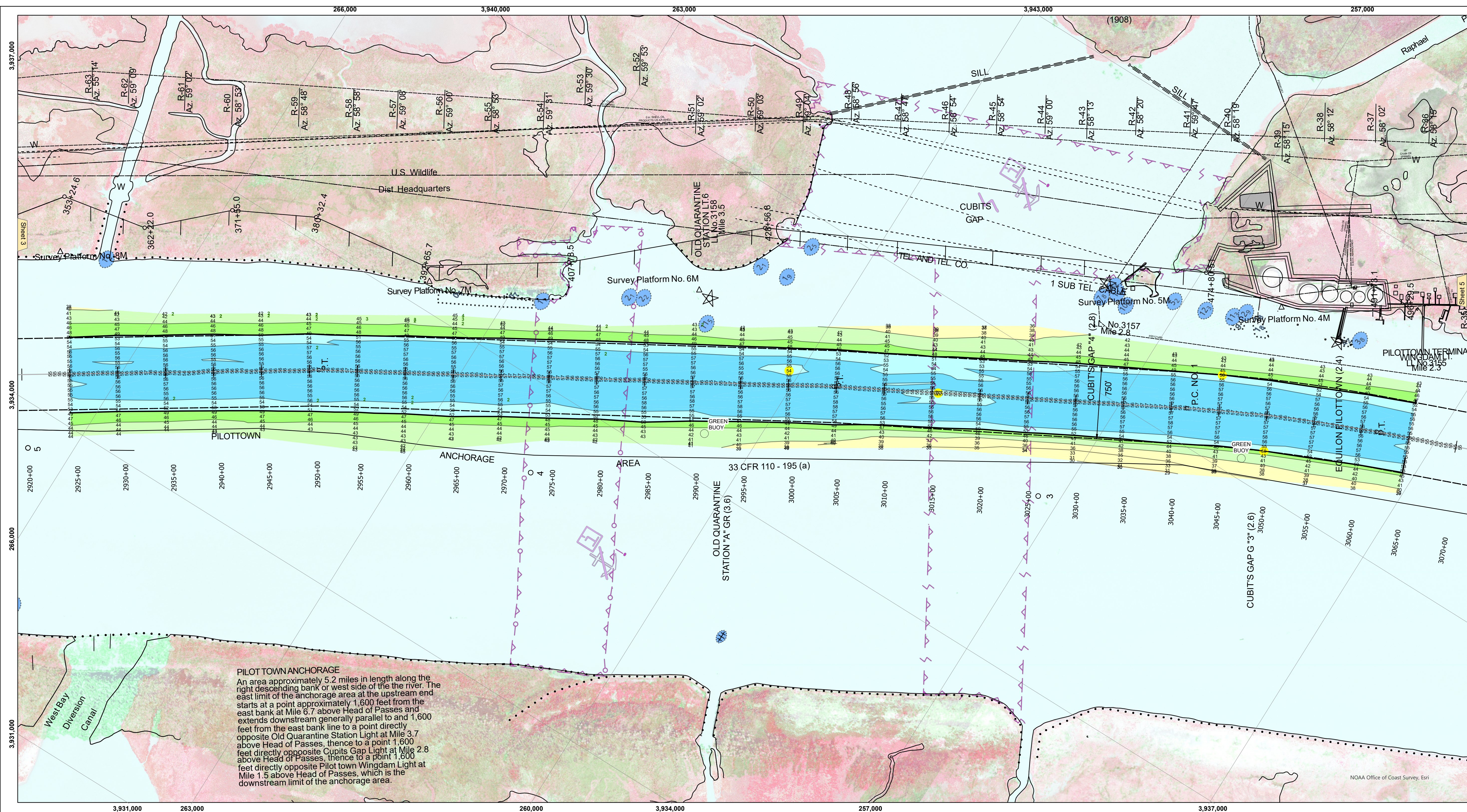

LEGEND

--- Federal Navigation Channel	○ Cable Area	3 Fluff Thickness (feet)*	■ -10' and above
— Federal Navigation Center Line	□ Placement Area	□ Borrow Area	■ -10' to -20'
— As-built Pipeline/Cable	□ Anchorage Area	● Shoalest Sounding**	■ -20' to -30'
..... Unconfirmed Pipeline/Cable	⊗ Obstruction Point	★ Beacon, General	■ -30' to -40'
— Project Depth Contour	⚓ Wrecks-Submerged	◆ Red Navigation Buoy	■ -40' to -45'
		◆ Green Navigation Buoy	■ -45' to -50'
			■ -50' to -55'
			■ -55' and below

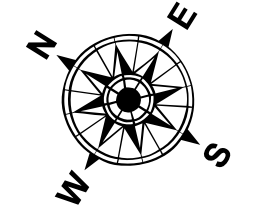

Gage Reading: 0.3 MLLW @ P.T. (01525) @ 1020
 Sea Conditions: CALM
 Vessel Name: TOBIN
 Survey Type: CONDITION, SB
 Sounding Frequency***: LOW

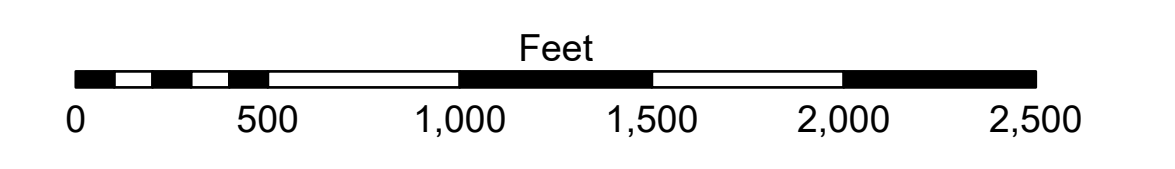

NOTES:
 Horizontal Coordinate System: North American Datum of 1983 (NAD83), projected to the State Plane Coordinate System (SPCS), Louisiana South Zone. Distance units in U.S. Survey Feet.
 Vertical Datum: Soundings are shown in feet and indicate depths below Mean Lower Low Water (MLLW, 12-16). Datum Relationships for gage 01525 as of March 2020: 0.0' NAVD83, 2009.55 = -0.53' MLLW = 2.97' MLG
 Distances on the Mississippi River, above and below Head of Passes are shown at 1 mile intervals.
 The location of navigation aids are base on and provided by the U.S. Coast Guard.
 2024 Aerial Photography data source: Optimal GEO (1998 DOQQ in green)
 Reference is N.O.A.A. Navigation Chart No. 11361.
 ** Shoalest Sounding per Quarter Per Reach.
 *** High frequency (200 kHz) survey data represents the first signal return at a sounding location and will include suspended solids, known as "fluff", if present. Low frequency (24 kHz) survey data normally penetrates through this "fluff" layer to depict elevations of consolidated bottom material. Low frequency accuracies may vary depending on channel conditions and fathometer settings.