

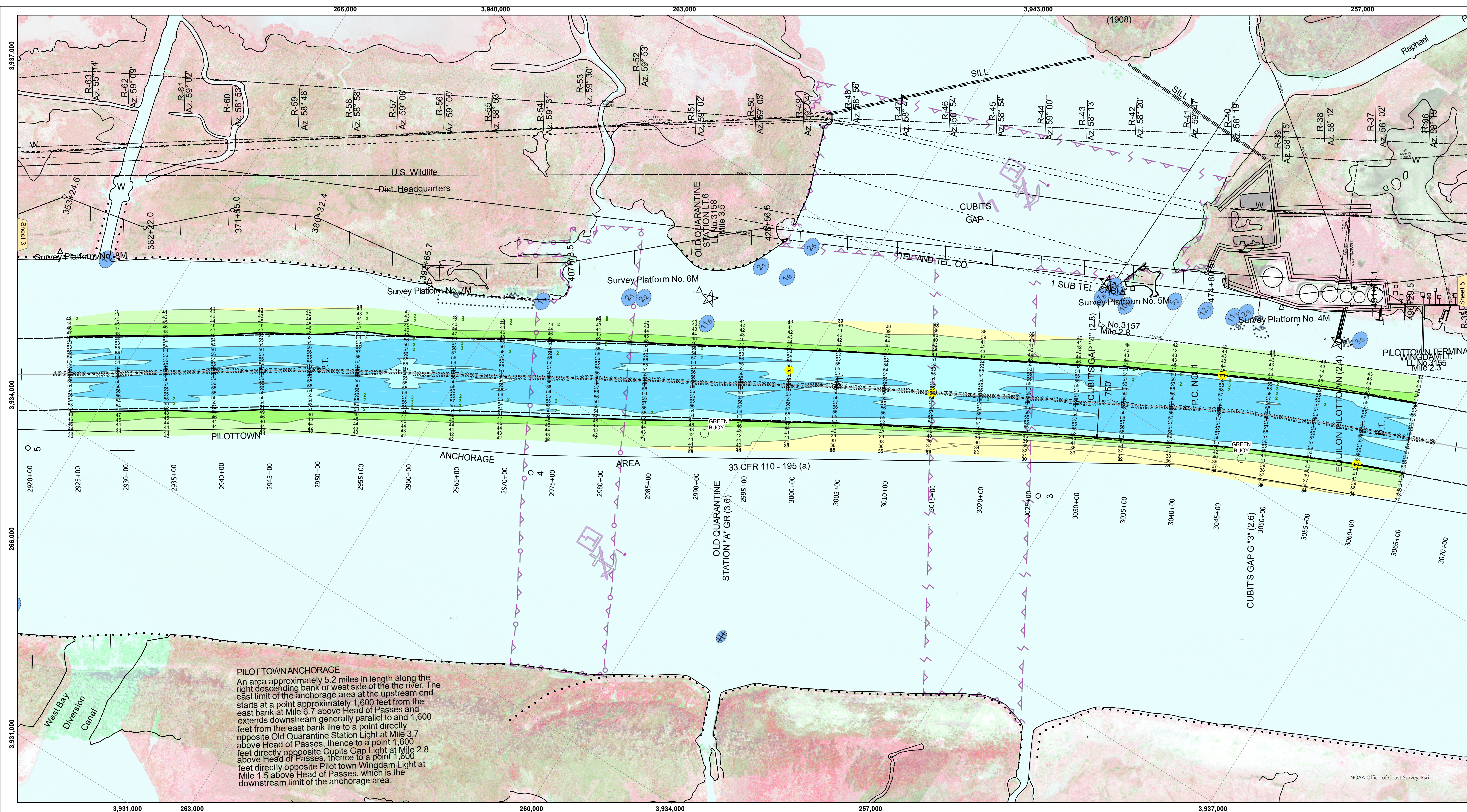

US Army Corps of Engineers District: CEMVN

DISTRICT LIABILITY: The data represents the results of data collection/processing for a specific US Army Corps of Engineers activity and is not intended for use for any other purpose. The user is responsible for the accuracy, completeness, and reliability of the data for other than its intended purpose. The user is responsible for the accuracy, completeness, and reliability of the data for other than its intended purpose. The user is responsible for the accuracy, completeness, and reliability of the data for other than its intended purpose.



PILOTTOWN ANCHORAGE
 An area approximately 5.2 miles in length along the right descending bank or west side of the river. The east limit of the anchorage area at the upstream end starts at a point approximately 1,600 feet from the east bank at Mile 6.7 above Head of Passes and extends downstream generally parallel to and 1,600 feet from the east bank line to a point directly opposite Old Quarantine Station Light at Mile 3.7 above Head of Passes, thence to a point 1,600 feet directly opposite Cubits Gap Light at Mile 2.8 above Head of Passes, thence to a point 1,600 feet directly opposite Pilot town Wingdam Light at Mile 1.5 above Head of Passes, which is the downstream limit of the anchorage area.

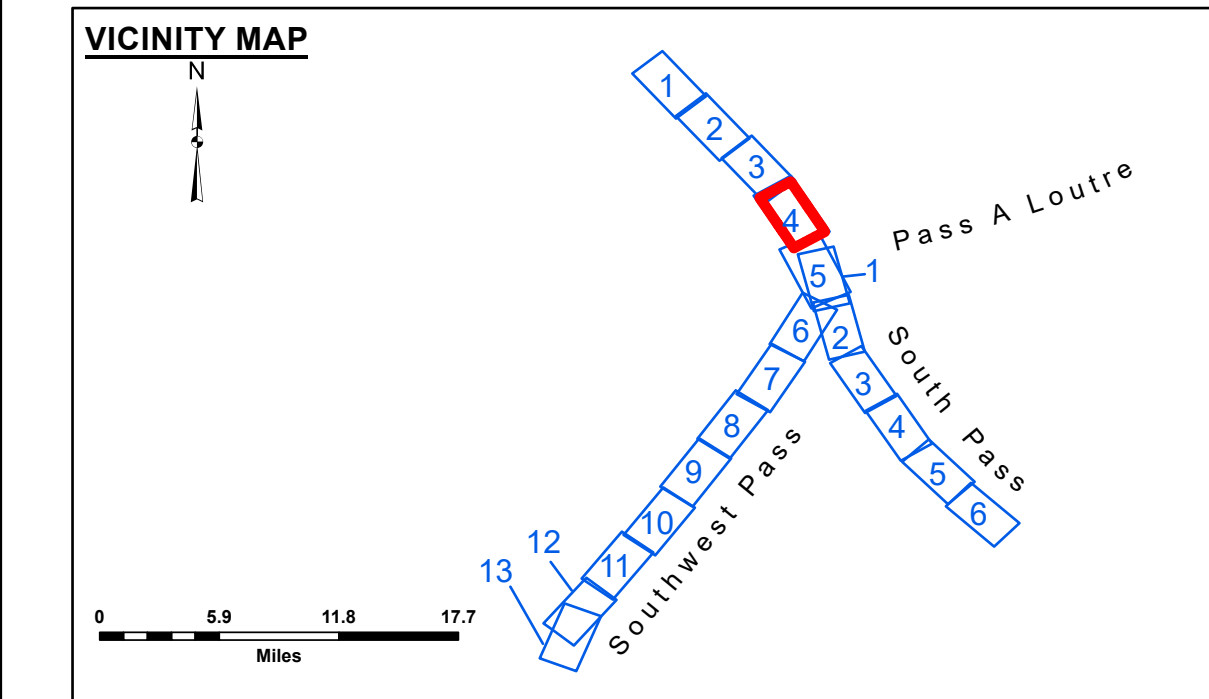

LEGEND		3 Fluff Thickness (feet)*	
--- Federal Navigation Channel	○ Cable Area	█ -10' and above	█ -10' to -20'
— Federal Navigation Center Line	□ Placement Area	█ -20' to -30'	█ -30' to -40'
— As-built Pipeline/Cable	⊗ Anchorage Area	█ -40' to -45'	█ -45' to -50'
..... Unconfirmed Pipeline/Cable	⊗ Obstruction Point	█ -50' to -55'	█ -55' and below
— Project Depth Contour	⚓ Wrecks-Submerged	★ Beacon, General	◆ Red Navigation Buoy
		◆ Green Navigation Buoy	

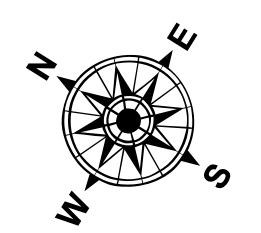

Gage Reading: 0.2 MLLW @ P.T. (01525) @ 1030
 Sea Conditions: CHOPPY
 Vessel Name: OB 173
 Survey Type: CONDITION, SB
 Sounding Frequency***: LOW

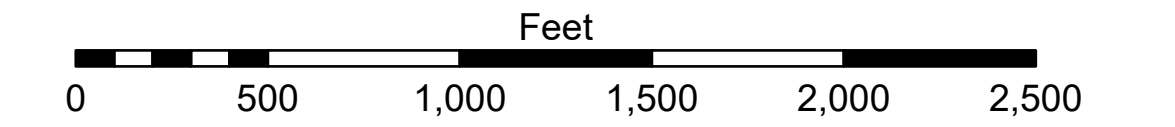

NOTES:
 Horizontal Coordinate System: North American Datum of 1983 (NAD83), projected to the State Plane Coordinate System (SPCS), Louisiana South Zone. Distance units in U.S. Survey Feet.
 Vertical Datum: Soundings are shown in feet and indicate depths below Mean Lower Low Water (MLLW, 12-16). Datum Relationships for gage 01525 as of March 2020: 0.0' NAVD83, 2009.55 = -0.53' MLLW = 2.97' MLG
 Distances on the Mississippi River, above and below Head of Passes are shown at 1 mile intervals.
 The location of navigation aids are base on and provided by the U.S. Coast Guard.
 2024 Aerial Photography data source: Optimal GEO (1998 DOQQ in green)
 Reference is N.O.A.A. Navigation Chart No. 11361.
 *** Shoalest Sounding per Quarter per Reach.
 *** High frequency (200 kHz) survey data represents the first signal return at a sounding location and will include suspended solids, known as "fluff", if present. Low frequency (24 kHz) survey data normally penetrates through this "fluff" layer to depict elevations of consolidated bottom material. Low frequency accuracies may vary depending on channel conditions and fathometer settings.

U.S. ARMY CORPS OF ENGINEERS NEW ORLEANS DISTRICT	
Submitted:	Surveyed By: JTB & DED
Recommended:	Plotted By: TSS
Approved:	Checked By: MSK

**MISSISSIPPI RIVER - B. R. TO GULF
 SOUTHWEST PASS - SHEET 4
 SW_04_SWPX_20241125_CS
 25 November 2024**

**Sheet Reference Number
 4 of 13**

Revision Number: 5.23.12.3-3.23.12.3