



US Army Corps of Engineers District: CEMVN

Accession: The United States Government furnishes these data and the recipient accepts and uses them with the express understanding that the data are not to be used for any purpose other than that for which they were originally prepared...

Table with 4 columns: Submitted, Recommended, Checked, Approved. Lists personnel: Surveyed By: LLB & DBD, Plotted By: RSL, Checked By: MSK, Approved: Chief Waterways Maintenance Section.

MISSISSIPPI RIVER - B.R. TO GULF SOUTHWEST PASS - SHEET 4 SW\_04\_SWP\_20200710\_CS 10 July 2020

Sheet Reference Number 4 of 13

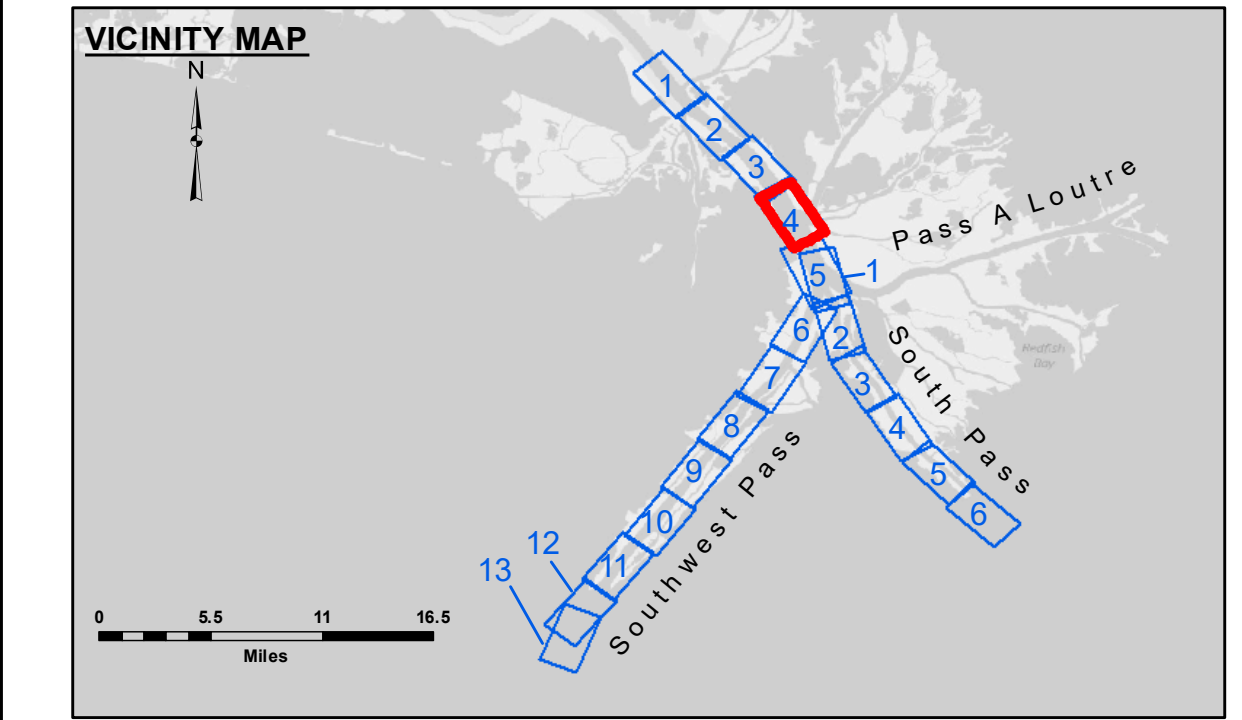
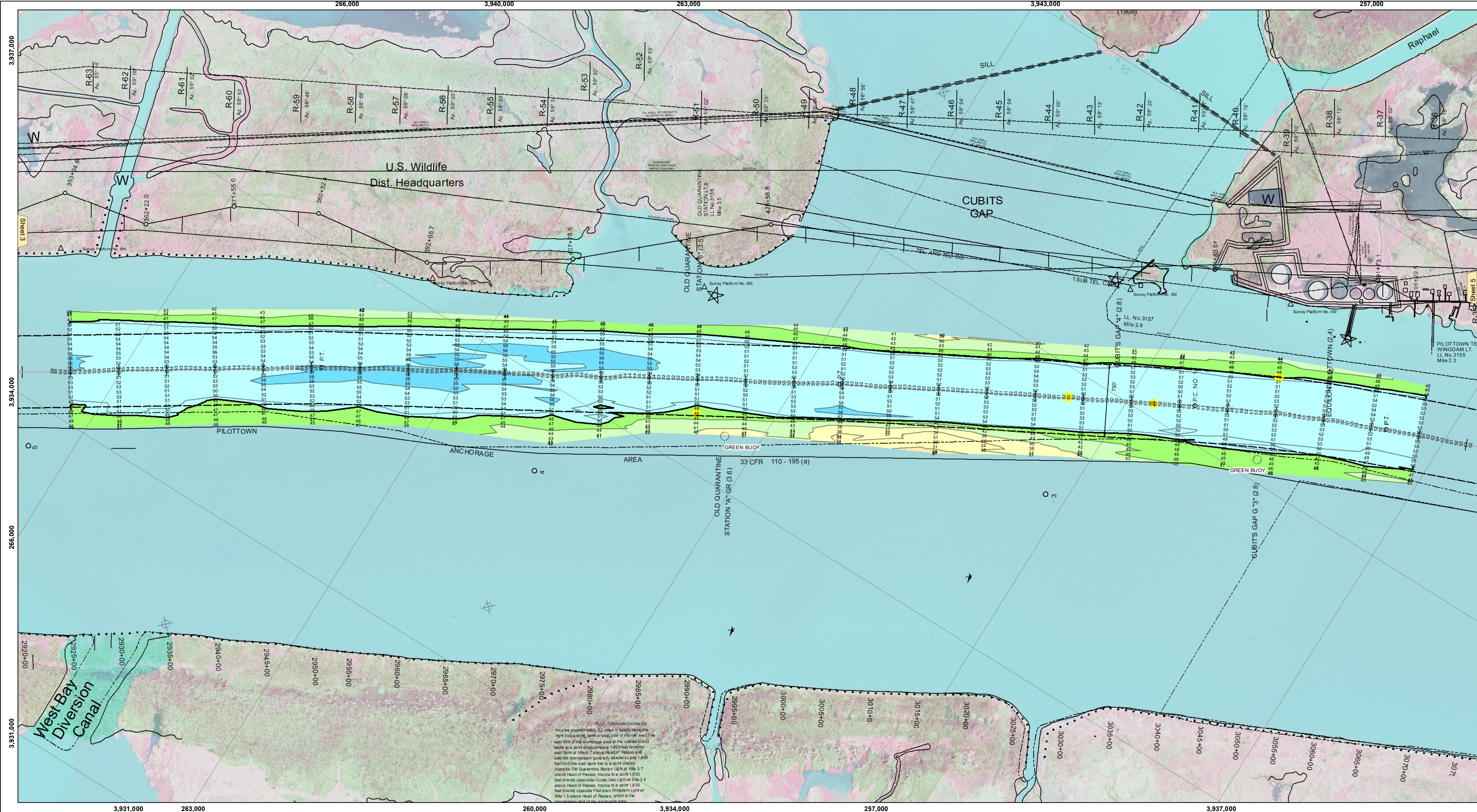

LEGEND: Federal Navigation Channel, Cable Area, Borrow Area, Placement Area, Shoalest Sounding\*\*, Anchorage Area, Obstruction Point, Wrecks-Submerged, As-built Pipeline/Cable, Unconfirmed Pipeline/Cable, Project Depth Contour, Beacon, General, Red Navigation Buoy, Green Navigation Buoy, and depth contours from -10' to -55' and below.

NOTES: Horizontal Coordinate System (North American Datum of 1983), Vertical Datum (Soundings in feet and indicate depths below Mean Lower Low Water), Gage Reading (0.8 MLLW @ PILOT TOWN @ 1145), Sea Conditions (CALM), Vessel Name (OB-173), Survey Type (CONDITION, SB), Sounding Frequency (LOW).

Notes detailing coordinate systems, datum relationships, and survey information. Reference is N.O.A. Navigation Chart No. 11361.