



DISCLAIMER: The data represents the results of data collection/processing for a specific US Army Corps of Engineers project and is only valid for its intended use. Content, time and accuracy are not guaranteed. The user is responsible for the results. Distribution of this data is not intended for use for any other purpose. Data Constants: Hydrographic survey data is subject to change frequently due to several factors including but not limited to dredging, shoaling, and other channel changes. The user is responsible for the results of the data. The information depicted on the map represents the results of a survey and is not intended to be used as a legal document. The information is for informational purposes only and should not be used to represent the general condition existing at that time.

Surveyed By:	JUC & MGF
Plotted By:	TSS
Checked By:	MSK
Submitted:	
Recommended:	Chief, Survey Section
Approved:	Chief, Waterways Maintenance Section

**MISSISSIPPI RIVER - B.R. TO GULF
SOUTHWEST PASS - SHEET 4
SW_04_SWP_20201125_CS
25 November 2020**

**Sheet
Reference
Number
4 of 13**

Revision Number:
4.1-20191105

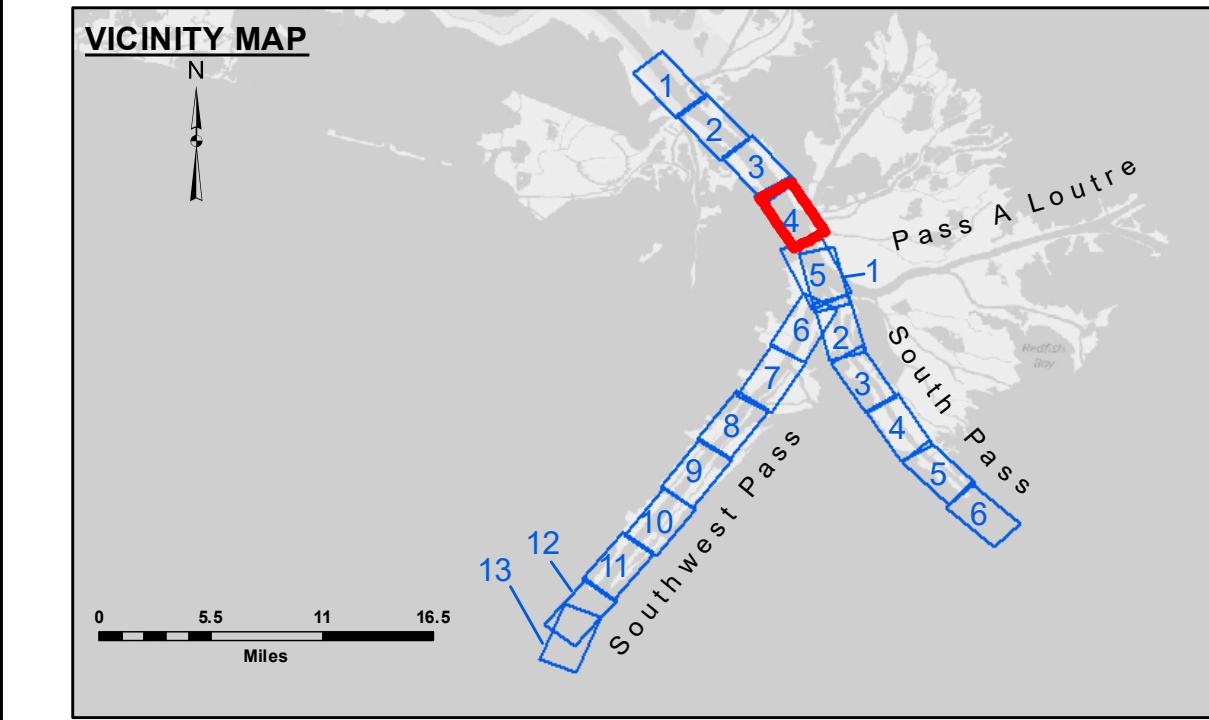
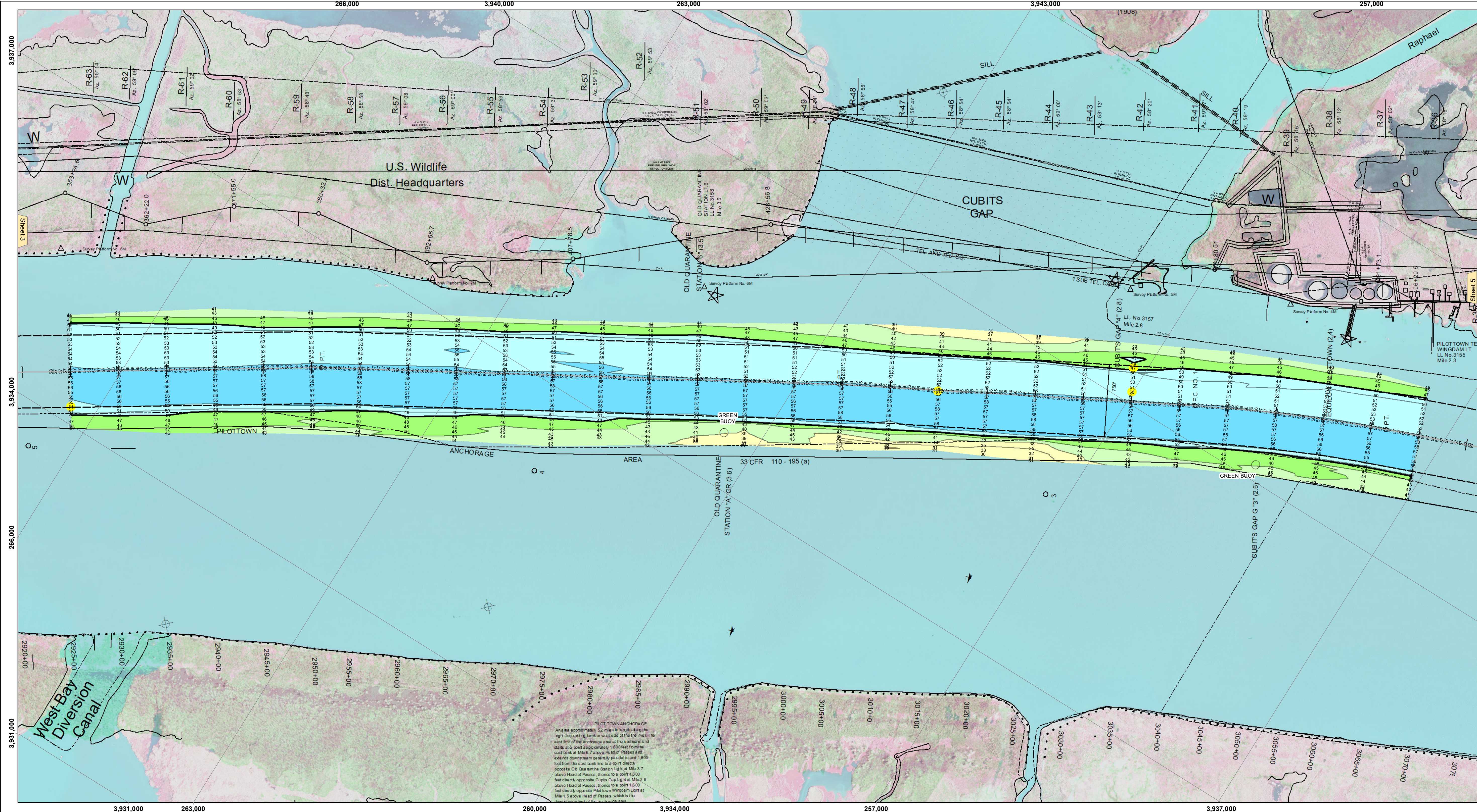

LEGEND			
--- Federal Navigation Channel	○ Cable Area	□ Borrow Area	-10' and above
— Federal Navigation Center Line	▭ Placement Area	● Shoalest Sounding**	-10' to -20'
— As-built Pipeline/Cable	⊗ Anchorage Area	★ Beacon, General	-20' to -30'
⋯ Unconfirmed Pipeline/Cable	⊗ Obstruction Point	◆ Red Navigation Buoy	-30' to -40'
— Project Depth Contour	✈ Wrecks-Submerged	◆ Green Navigation Buoy	-40' to -45'
			-45' to -48.5'
			-48.5' to -55'
			-55' and below

NOTES:

Horizontal Coordinate System:
North American Datum of 1983 (NAD83), projected to the State Plane Coordinate System (SPCS), Louisiana South Zone. Distance units in U.S. Survey Feet.

Vertical Datum:
Soundings are shown in feet and indicate depths below Mean Lower Low Water (MLLW, 07-11).
Datum Relationships for gage 01525 as of July 2015:
0.0' NAVD86 = -0.3' MLLW = 3.20' MLG

Distances on the Mississippi River, above and below Head of Passes are shown at 1 mile intervals.

The location of navigation aids are base on and provided by the U.S. Coast Guard.

2016 Aerial Photography data source: Precision Aerial Reconnaissance, LLC (1998 DOQQ in green)

Reference is N.O.A. Navigation Chart No. 11361.

** Shoalest Sounding per Quarter per Reach.

*** High frequency (200 kHz) survey data represents the first signal return at a sounding location and will include suspended solids, known as "fluff", if present. Low frequency (24 kHz) survey data normally penetrates through this "fluff" layer to depict elevations of consolidated bottom material. Low frequency accuracies may vary depending on channel conditions and fathometer settings.

Gage Reading: 0.9 MLLW @ PILOT TOWN @ 0825
Sea Conditions: CALM
Vessel Name: BEAUVAIS
Survey Type: CONDITION, SB
Sounding Frequency***: LOW

PILOT TOWN ANCHORAGE
An area approximately 5.2 miles in length along the right channel bank or west side of the Old and New Passes. The anchorage area is located between the east bank at Mile 2.7 above Head of Passes and extends down stream generally parallel to and 1,500 feet from the east bank line to a point directly opposite the Old Quarantine Station Light at Mile 2.8 above Head of Passes, thence to a point 1,500 feet directly opposite Cubits Gap Light at Mile 2.3 above Head of Passes, thence to a point 1,500 feet directly opposite Pilot Town Wingdam Light at Mile 1.5 above Head of Passes, which is the western limit of the anchorage area.

33 CFR 110 - 195 (a)
OLD QUARANTINE STATION "A" GR (3.6)

PILOT TOWN ANCHORAGE
An area approximately 5.2 miles in length along the right channel bank or west side of the Old and New Passes. The anchorage area is located between the east bank at Mile 2.7 above Head of Passes and extends down stream generally parallel to and 1,500 feet from the east bank line to a point directly opposite the Old Quarantine Station Light at Mile 2.8 above Head of Passes, thence to a point 1,500 feet directly opposite Cubits Gap Light at Mile 2.3 above Head of Passes, thence to a point 1,500 feet directly opposite Pilot Town Wingdam Light at Mile 1.5 above Head of Passes, which is the western limit of the anchorage area.