

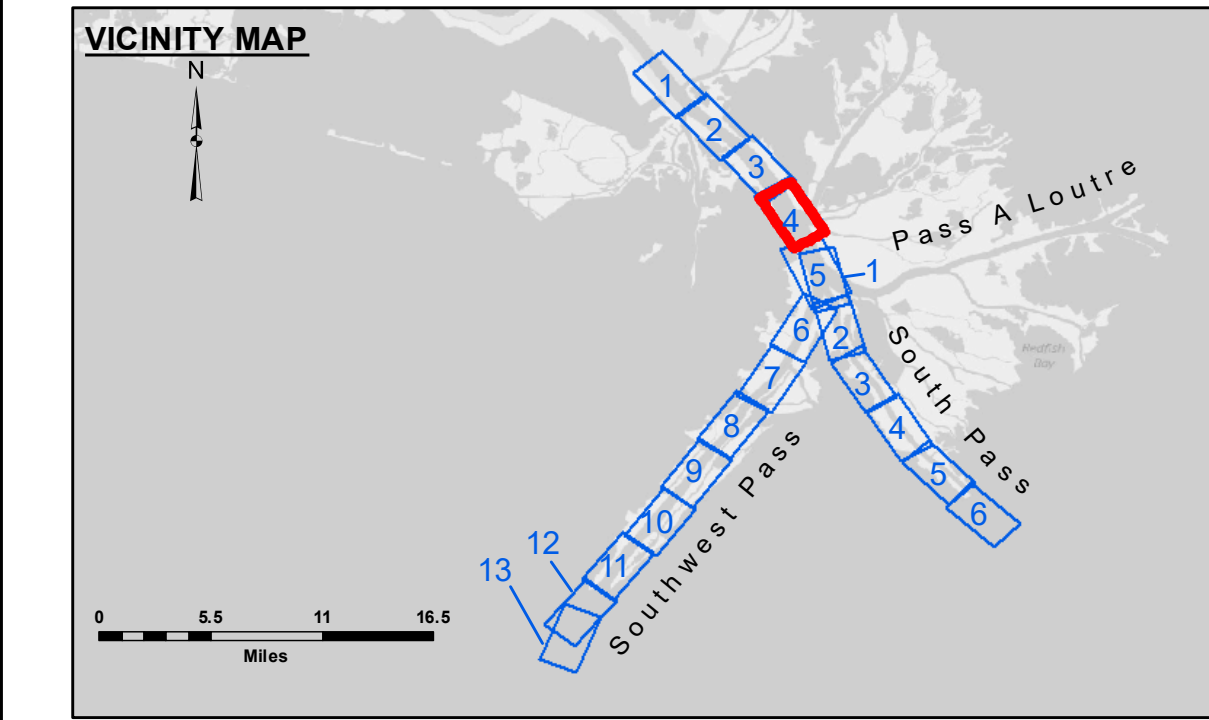

DISCLAIMER
 The United States Government furnishes these data and the recipient accepts and uses them with the express understanding that the data are not to be used for any purpose other than that for which they were prepared, or implied concerning the accuracy, completeness, reliability, usability, or suitability for any particular purpose of the recipient. The user is responsible for the results of any use of the data. The United States Government does not warrant, either expressly or impliedly, that the data are free from errors or omissions, or that they will be suitable for any particular purpose. The recipient may not transfer these data to others without the written consent of the United States Government. The recipient may not transfer these data to others without the written consent of the United States Government. The recipient may not transfer these data to others without the written consent of the United States Government. The recipient may not transfer these data to others without the written consent of the United States Government. The recipient may not transfer these data to others without the written consent of the United States Government. The recipient may not transfer these data to others without the written consent of the United States Government. The recipient may not transfer these data to others without the written consent of the United States Government. The recipient may not transfer these data to others without the written consent of the United States Government. The recipient may not transfer these data to others without the written consent of the United States Government. The recipient may not transfer these data to others without the written consent of the United States Government. The recipient may not transfer these data to others without the written consent of the United States Government. The recipient may not transfer these data to others without the written consent of the United States Government. The recipient may not transfer these data to others without the.PILOT TOWN WINGDAM LT. LL No. 3155 Mile 2.3

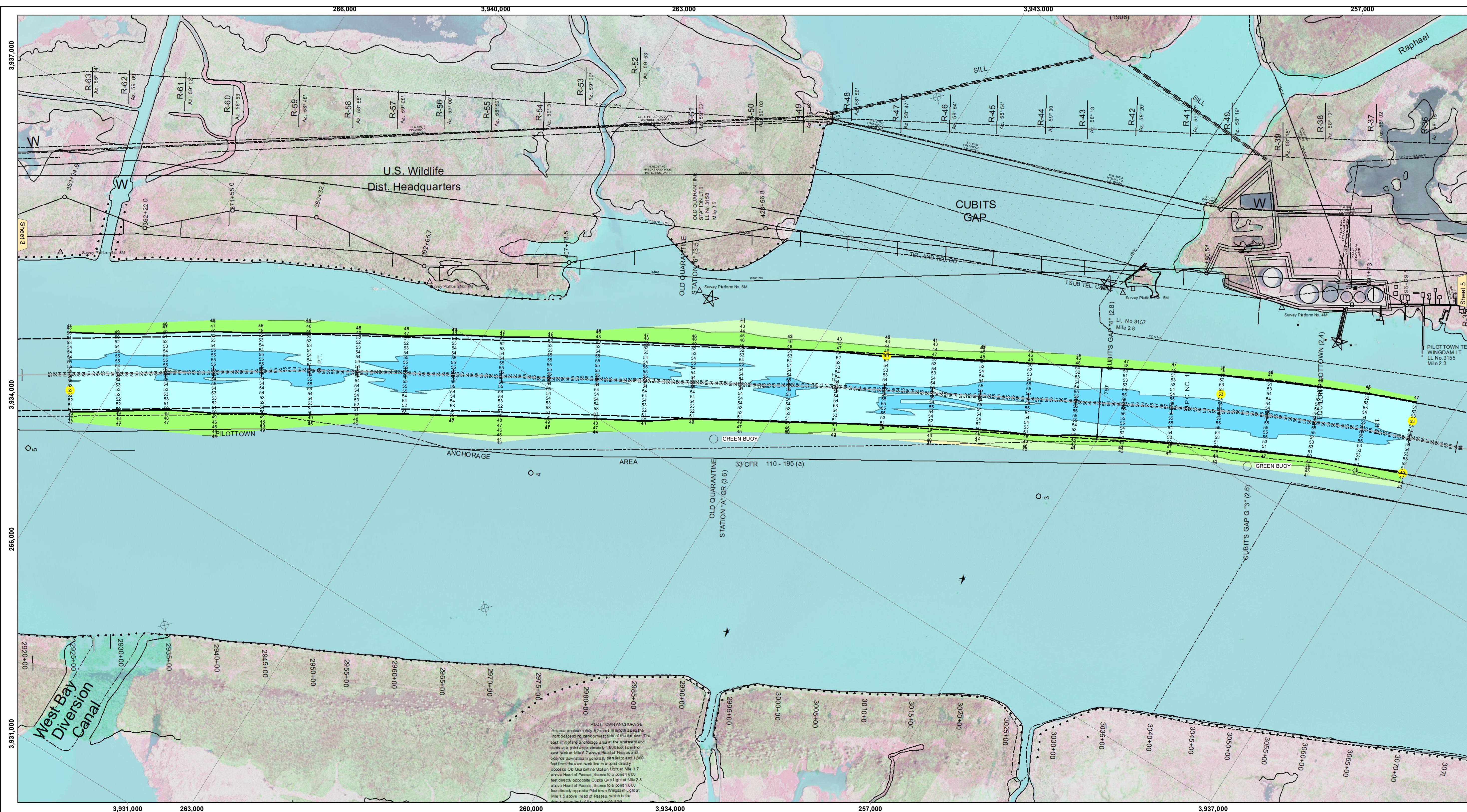

LEGEND

--- Federal Navigation Channel	● Cable Area	□ Borrow Area	■ -10' and above
— Federal Navigation Center Line	■ Placement Area	● Shoalest Sounding**	■ -10' to -20'
— As-built Pipeline/Cable	□ Anchorage Area	★ Beacon, General	■ -20' to -30'
..... Unconfirmed Pipeline/Cable	⊗ Obstruction Point	◆ Red Navigation Buoy	■ -30' to -40'
— Project Depth Contour	⚓ Wrecks-Submerged	◆ Green Navigation Buoy	■ -40' to -45'
			■ -45' to -50'
			■ -50' to -55'
			■ -55' and below

Gage Reading: -0.1 MLLW @ PILOT TOWN @ 0925
 Sea Conditions: CALM
 Vessel Name: BEAUVAIS
 Survey Type: CONDITION, SB
 Sounding Frequency***: LOW

Vertical Datum:
 Soundings are shown in feet and indicate depths below Mean Lower Low Water (MLLW, 12-16).
 Datum Relationships for gage 01525 as of March 2020:
 0.0' NAVD88, 2009.55 = -0.53' MLLW = 2.97' MLG

Distances on the Mississippi River, above and below Head of Passes are shown at 1 mile intervals.

The location of navigation aids are base on and provided by the U.S. Coast Guard.

2016 Aerial Photography data source: Precision Aerial Reconnaissance, LLC (1998 DOQQ in green)

Reference is N.O.A. Navigation Chart No. 11361.

** Shoalest Sounding per Quarter per Reach.

*** High frequency (200 kHz) survey data represents the first signal return at a sounding location and will include suspended solids, known as "fluff", if present. Low frequency (24 kHz) survey data normally penetrates through this "fluff" layer to depict elevations of consolidated bottom material. Low frequency accuracies may vary depending on channel conditions and fathometer settings.

**U.S. ARMY CORPS OF ENGINEERS
 NEW ORLEANS DISTRICT**

Submitted:	Surveyed By: JH & RCC
Recommended: Chief, Survey Section	Plotted By: RSL
Approved: Chief, Waterways Maintenance Section	Checked By: MSK

**MISSISSIPPI RIVER - B.R. TO GULF
 SOUTHWEST PASS - SHEET 4
 SW_04_SWP_20211227_CS
 27 December 2021**

**Sheet Reference Number
 4 of 13**

Revision Number:
 4.2-20210429